



VERPAN
PREMIUM DESIGN

| ALU DOORS |

CATALOGUE _ V01



VERPAN
PREMIUM DESIGN

VERPAN is a family owned company. We are producing Entrance doors as well as door panels and interior doors. Our products are widely spread around the world.

Your entrance door at a glance

Entrance door is not only an element you need, it's the element that defines you.

It's the element that defines your personality, your love and your concern for your home. It's the element that provides you with safety and warmth.

We produce high - quality durable entrance doors

We make high quality entrance doors from aluminum combined with stainless steel and glass, in various designs, across different styles, in all Price ranges.

Our primary goal is to produce high quality products.

Our top priority is the satisfaction of our customers.

Follow your style with our high - quality entrance doors.

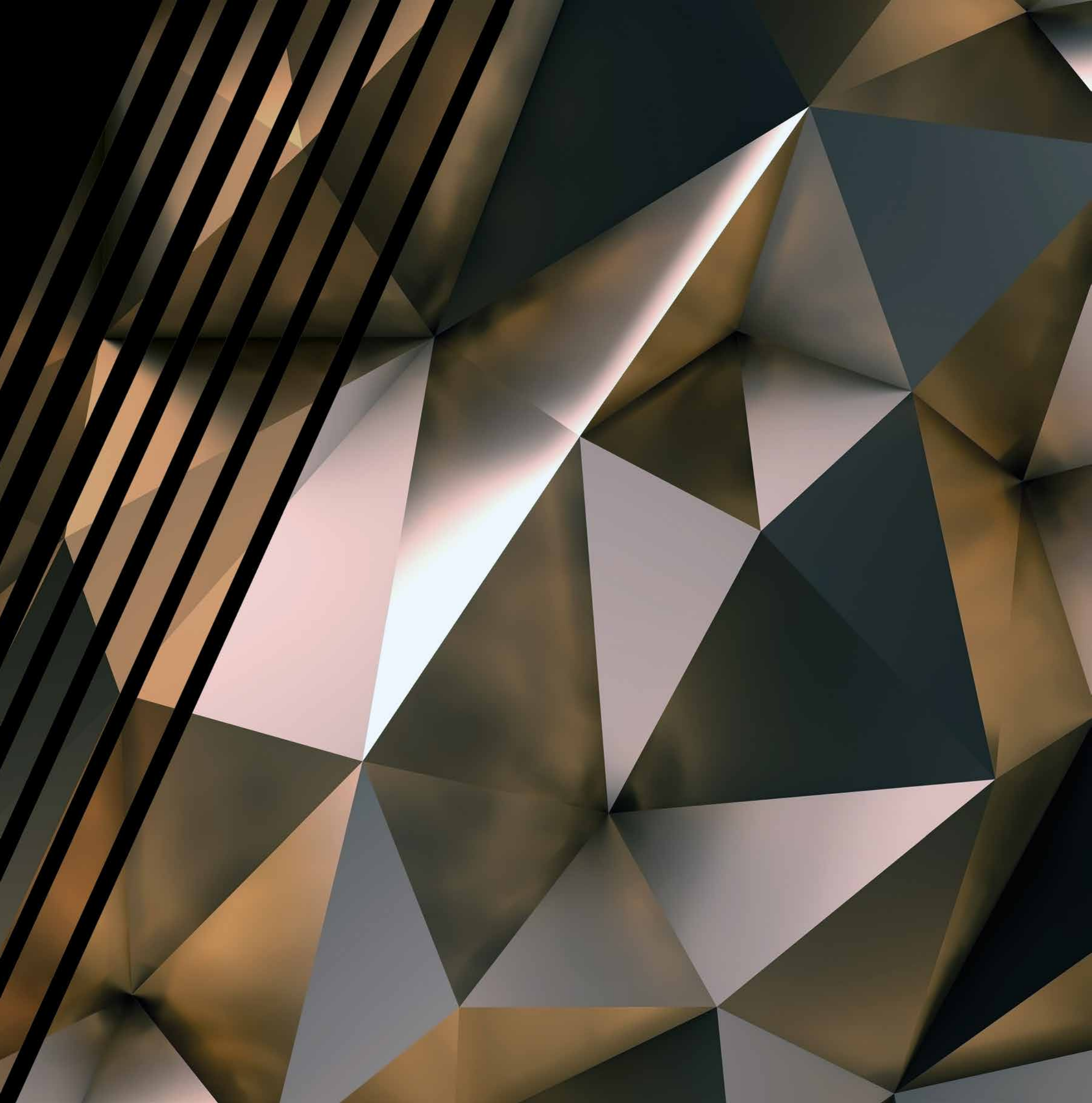

SUPERIOR 3DLINE



VERPAN
PREMIUM DESIGN

SUPERIOR 3DLINE

For some people one way is not enough!

They need more.
They need bright strength and luminous art.
They need a door like Superior 3d Entrance.

SUPERIOR 3D
LINE





V10100



V10201

**SUPERIOR 3D
LINE**



V10104



V10301



V10101



VERPAN | SUPERIOR 3D GIRAFFELINE

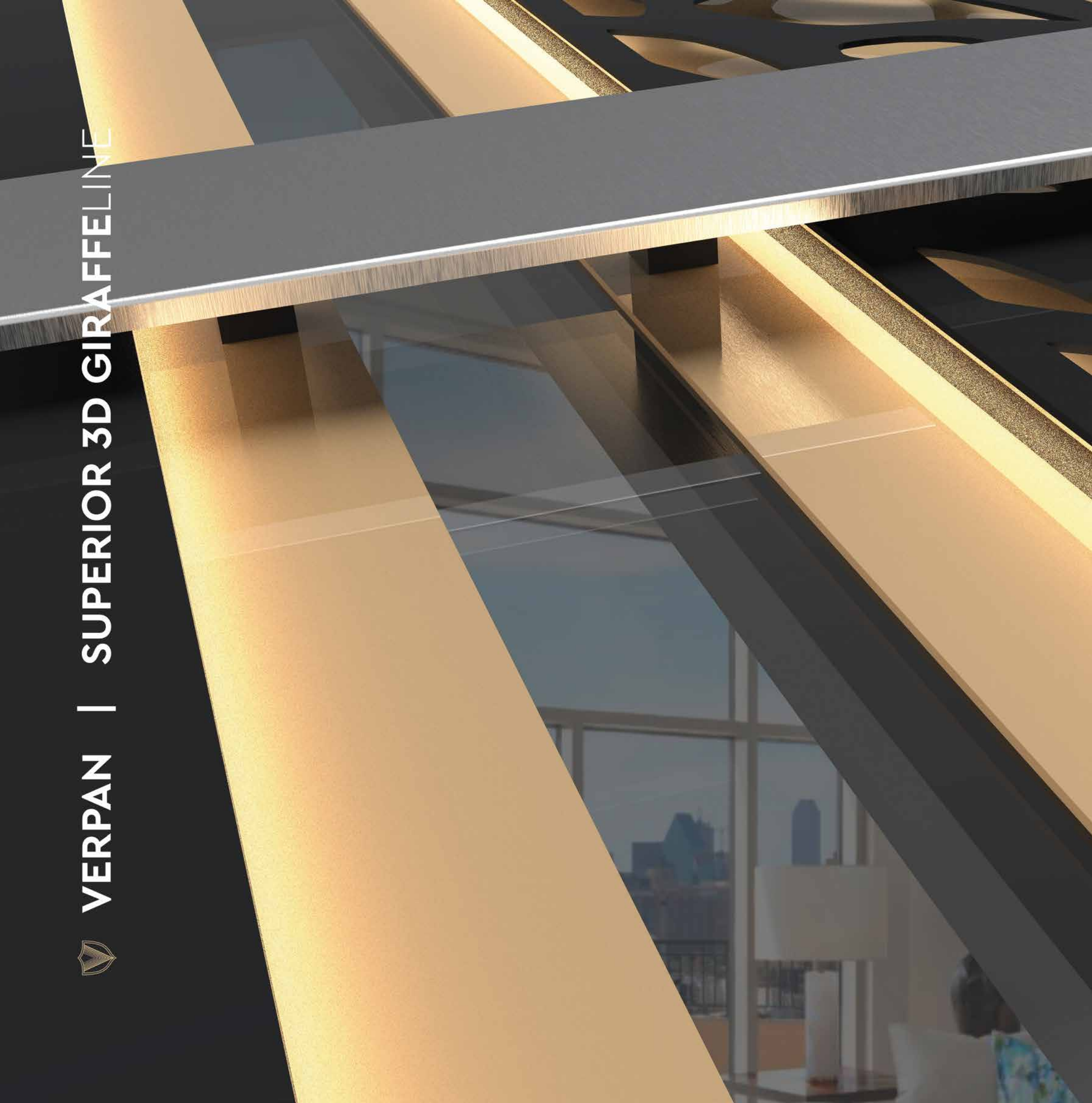

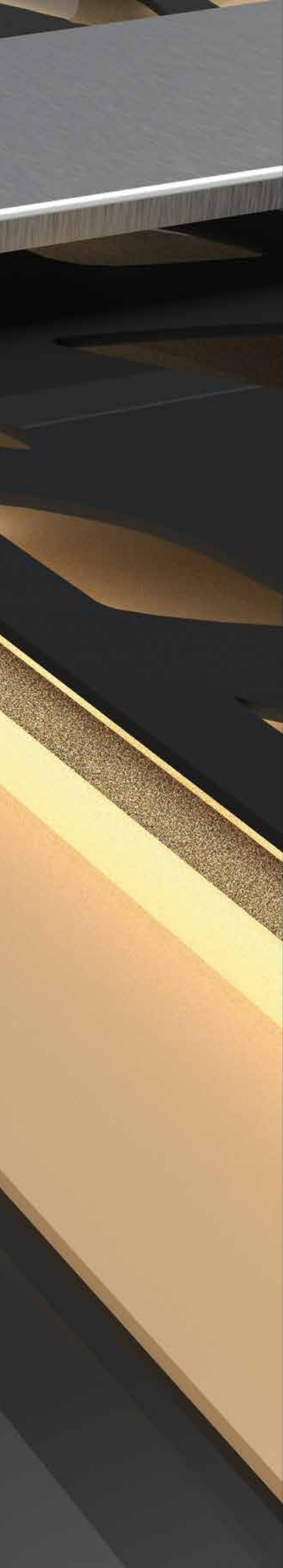

SUPERIOR 3D GIRAFFELINE

An entrance that glows.

Inspired from nature!

**SUPERIOR 3D
GIRAFFELINE**



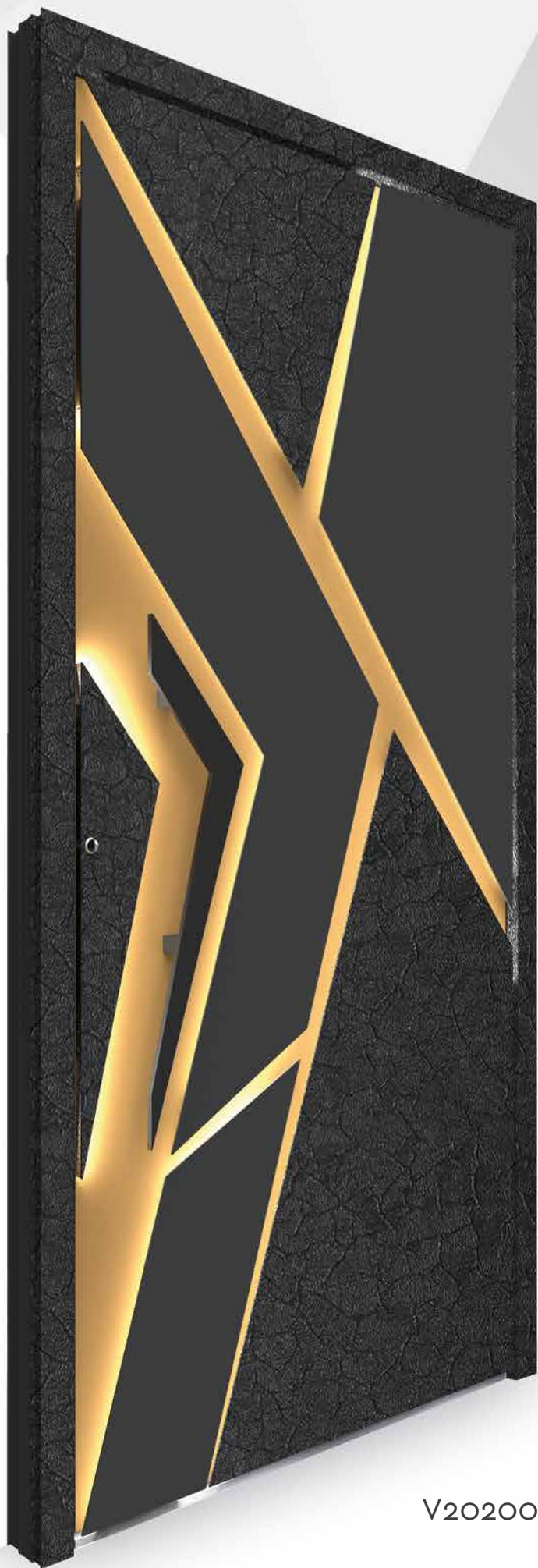

V20200



V20201

**SUPERIOR 3D
GIRAFFELINE**

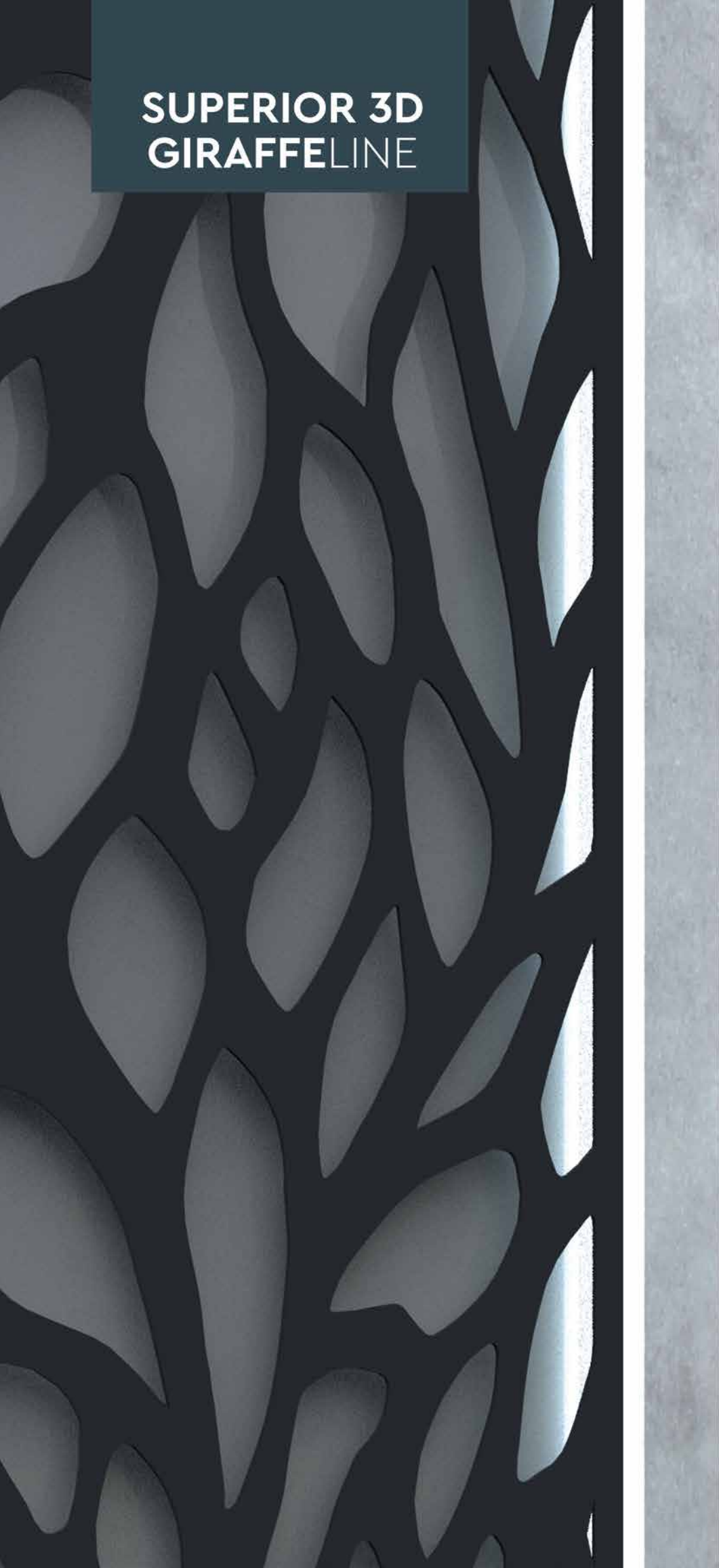

V20202



V20203



V20204

SUPERIOR 3D LINE

STANDARD EQUIPMENT

Both - sided sash overlapping panel 95.5mm. Aluminium thickness 3mm and 2x2mm. Inox ornaments on the same level with alu sheets.

- > **3 hinges** Rollenband 3D
- > **Inside handle** Inox ID-35
- > **Outside Handle Angular**
inox 1600mm placed on panel
- > **Glazing** 4 glasses, safety glass inside and outside 33.1+4+4+33.1
- > **Safety cylinder** with five keys
- > **Rosette ring**
- > **3 point** security door locking system with hooks
- > **Anodised Threshold**
- > **Ud = 0.81 W/m²K**

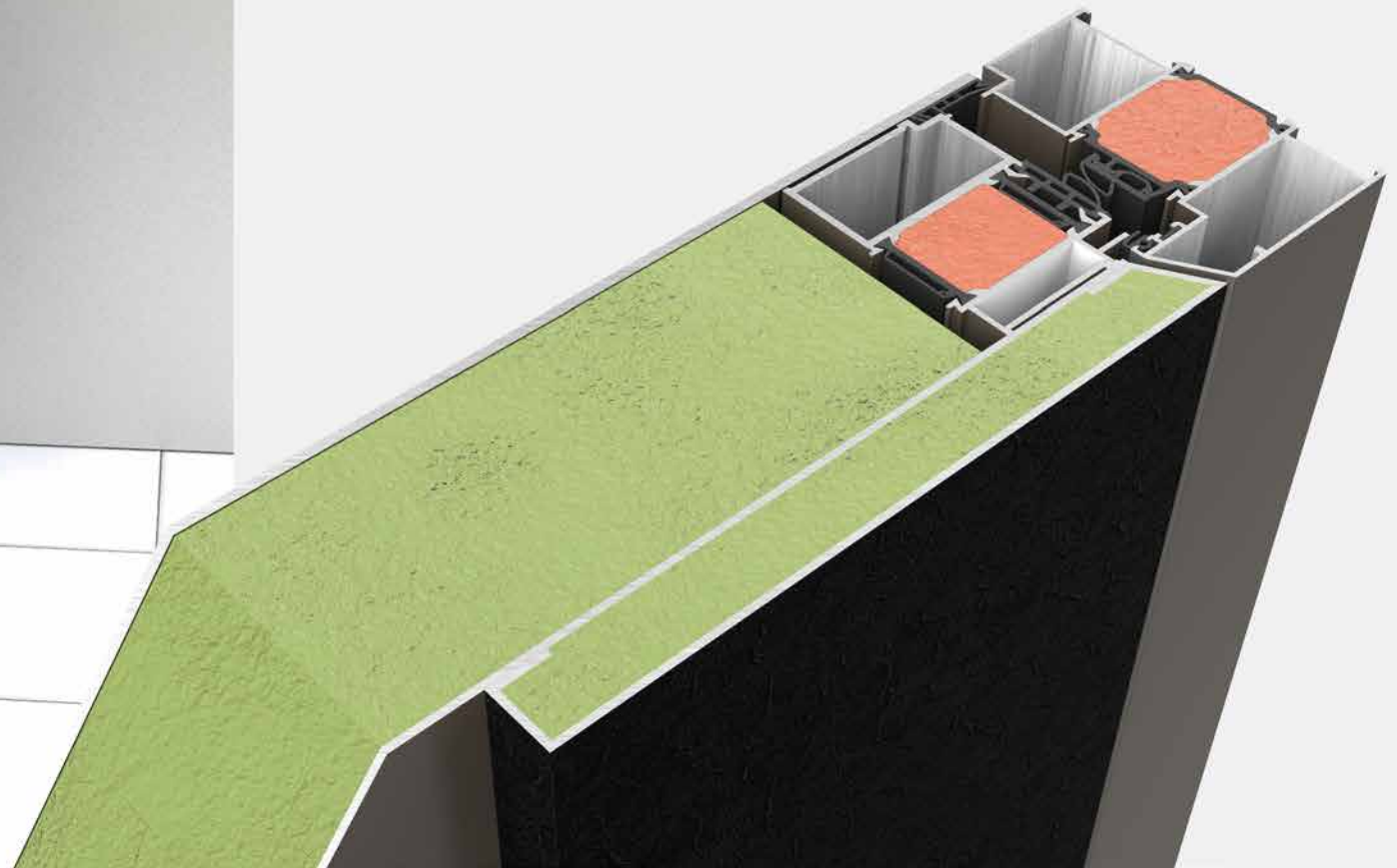

SUPERIOR 3D LINE

STANDARD EQUIPMENT



4 glasses, safety glass inside and outside 33.1+4+4+33.1



Safety cylinder EX-200



Round rosette EX-900



Rollenband EX-304



Inside Handle ID-35 EX-502



OUTSIDE HANDLE 1600MM
V440.60.1600

3 point hooklock



EX-100

VERTICAL SECTION

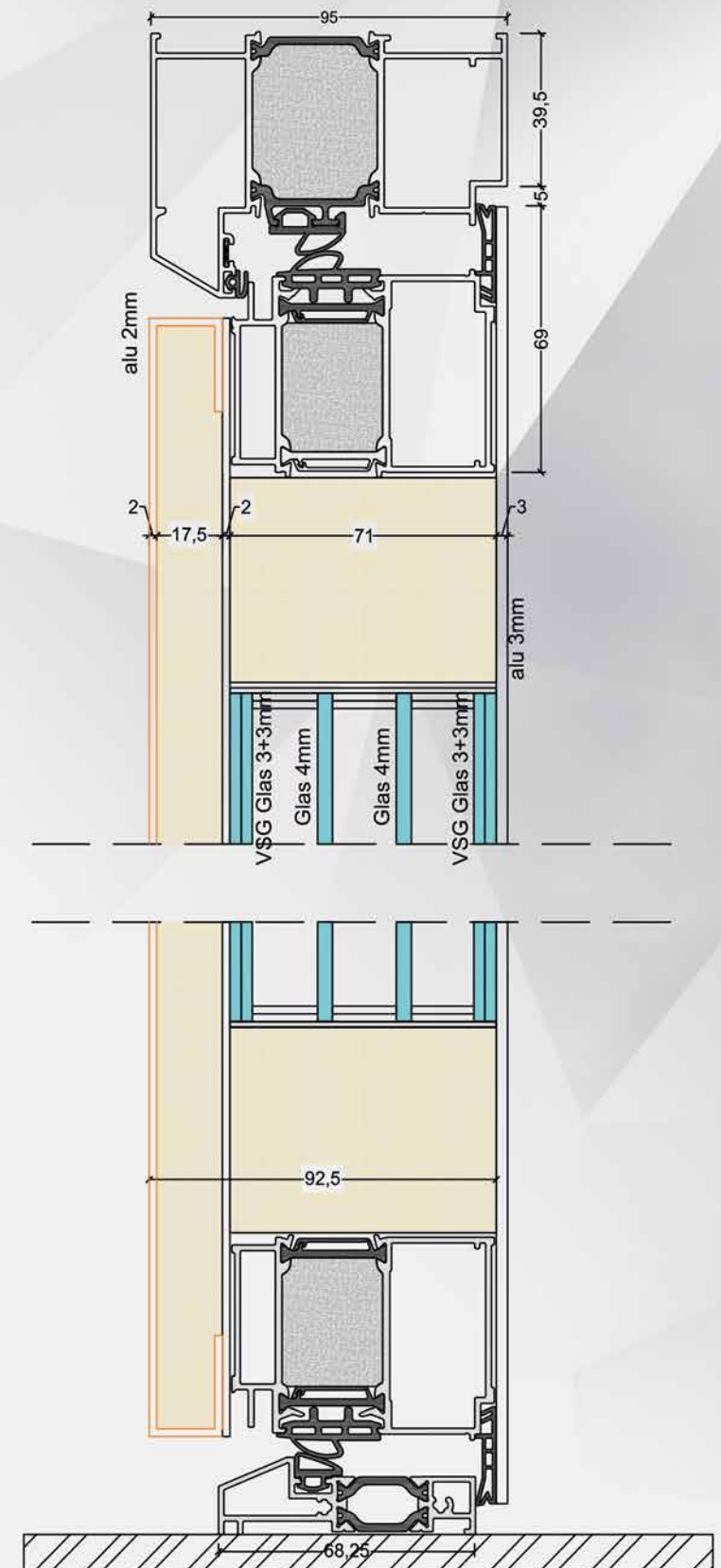

AVANTAGELINE

ELWITL 06-03-2018





AVANTAGELINE

The absolute flat!
Touch and feel a refined, flat, glassy surface.

Install an Entrance door from Avantage line.
Let people wonder what is behind!!!

AVANTAGE
LINE





VO143
AVANTAGE | ELEGRAND LINE

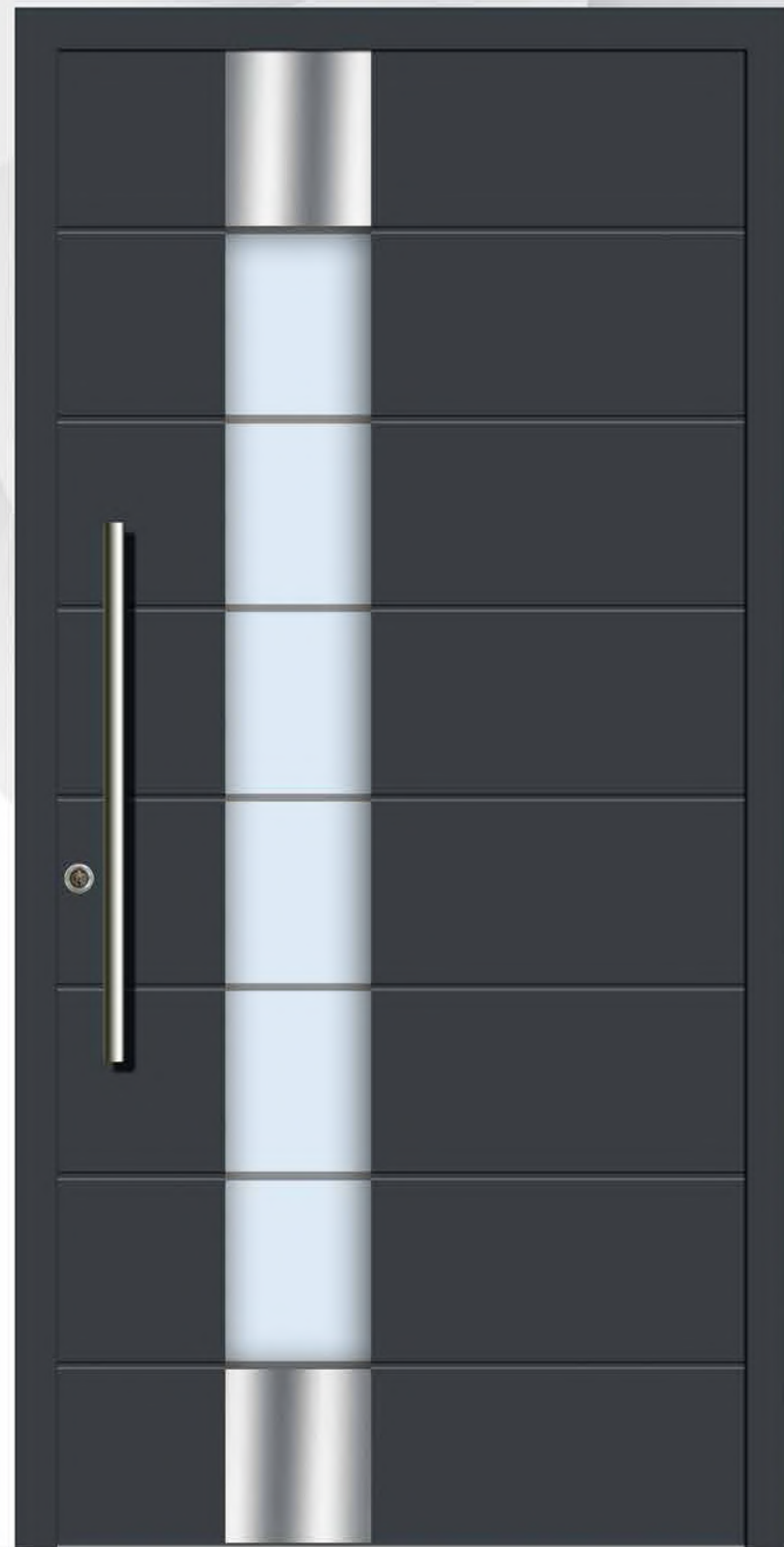

VO170
AVANTAGE | ELEGRAND LINE

AVANTAGE LINE



VO480
AVANTAGE LINE



VO220
AVANTAGE LINE



VO232
AVANTAGE | ELEGRAND LINE

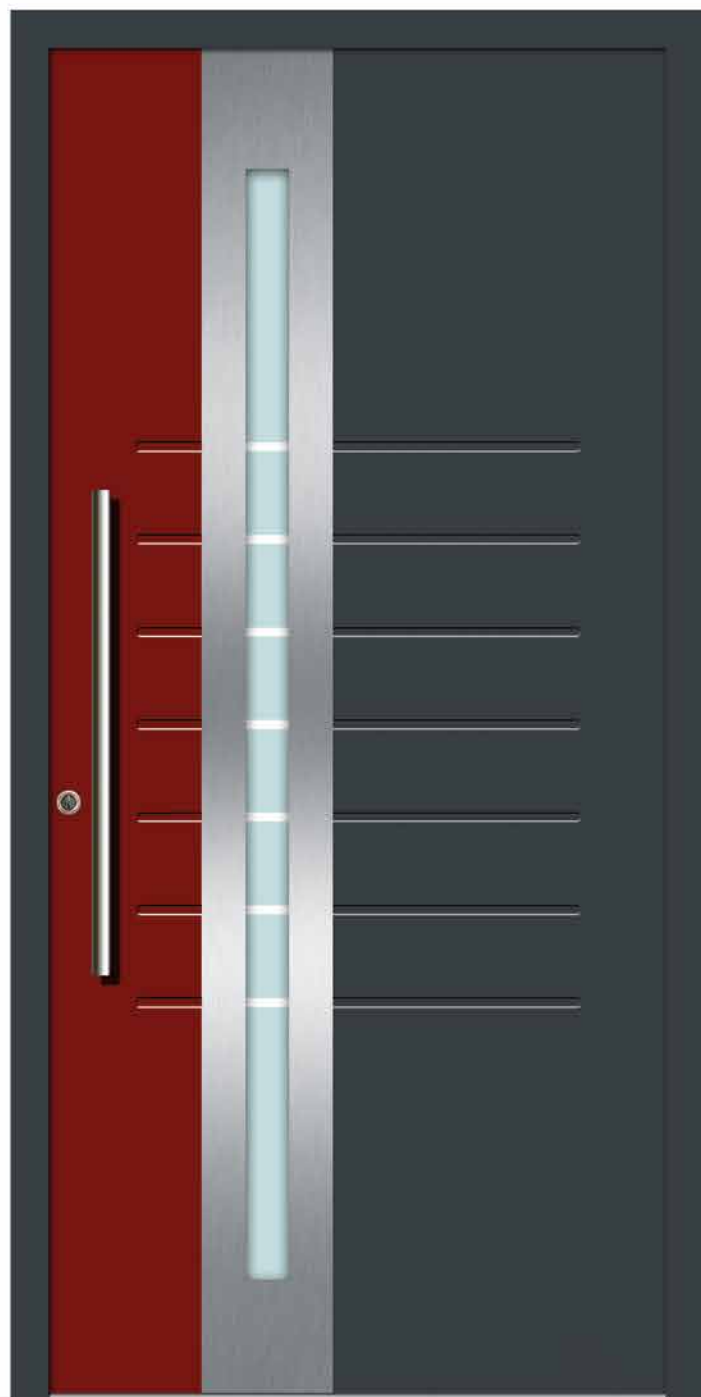

VO321

AVANTAGE | ELEGRAND LINE



AVANTAGE
LINE



VO340
AVANTAGE | ELEGRAND LINE



VO430
AVANTAGE LINE



VO453
AVANTAGE | ELEGRAND LINE

AVANTAGE LINE



VO462
AVANTAGE | ELEGRAND LINE



VO463
AVANTAGE | ELEGRAND LINE



VO470
AVANTAGE | ELEGRAND LINE



VO103
AVANTAGE | ELEGRAND LINE

AVANTAGE LINE

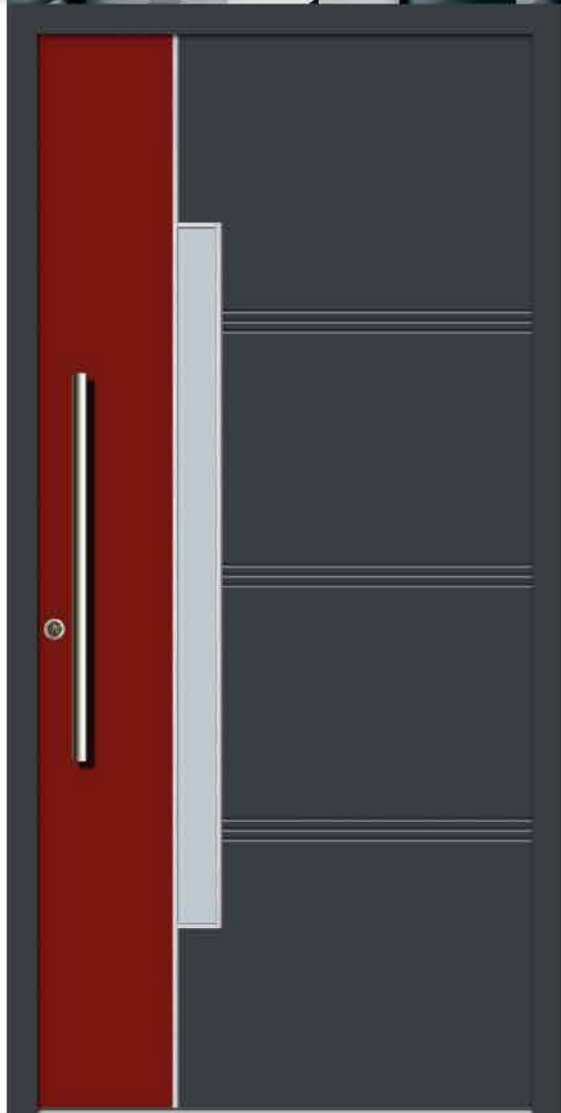

Vo500
AVANTAGE | ELEGRAND LINE



Vo502
AVANTAGE | ELEGRAND LINE



Vo560
AVANTAGE | ELEGRAND LINE



V1330
AVANTAGE | ELEGRAND LINE



V1350
AVANTAGE | ELEGRAND LINE

AVANTAGE LINE



V1360
AVANTAGE | ELEGRAND LINE

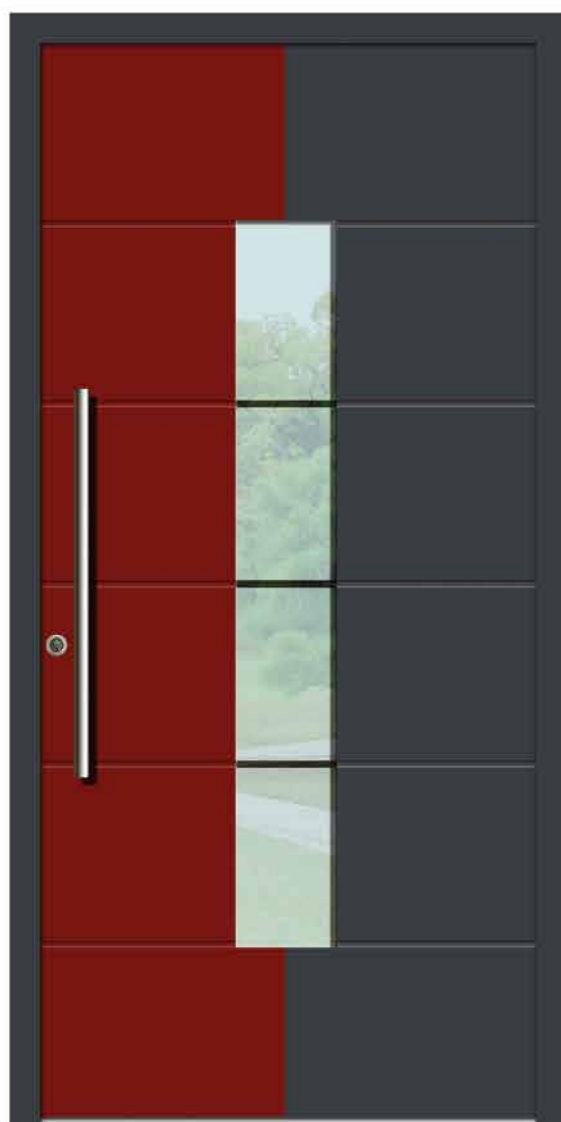

V1390
AVANTAGE | ELEGRAND LINE

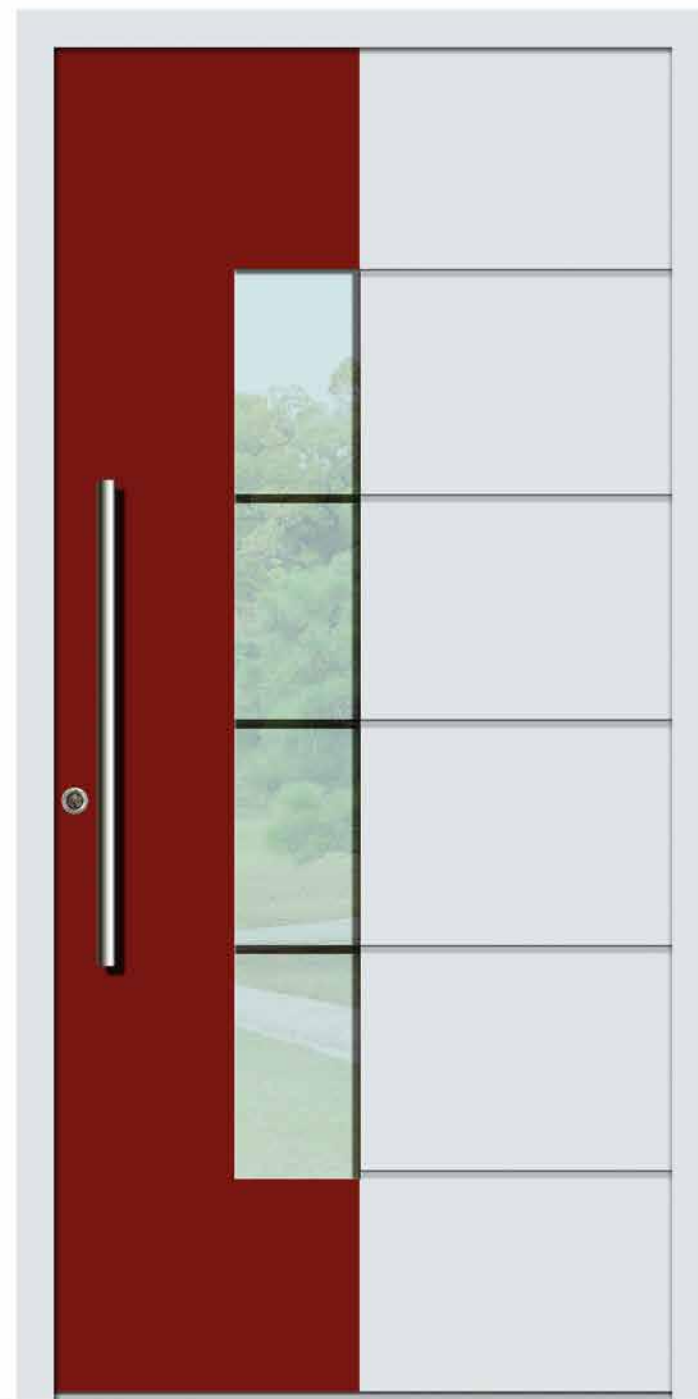

V1400
AVANTAGE | ELEGRAND LINE

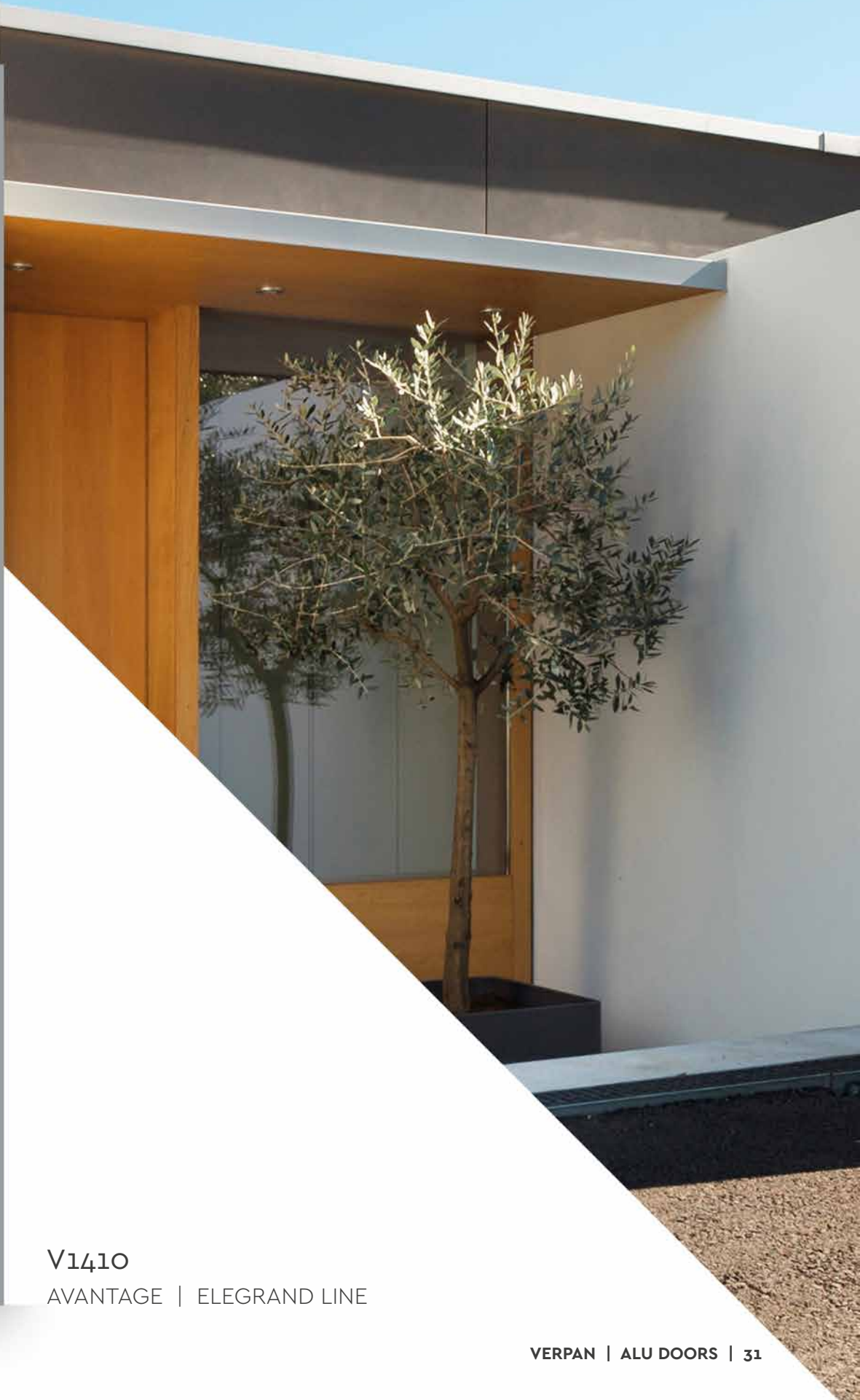

V1410
AVANTAGE | ELEGRAND LINE

AVANTAGE
LINE



V1220
AVANTAGE | ELEGRAND LINE



V1230
AVANTAGE | ELEGRAND LINE



V1300
AVANTAGE | ELEGRAND LINE

AVANTAGE LINE

STANDARD EQUIPMENT

Both - sided sash overlapping panel 77mm. Aluminium thickness 3mm and 3mm. Inox ornaments on the same level with alu sheets.

- > **3 hinges** 3D
- > **Inside handle** Inox ID-20
- > **Outside Handle Round**
inox 800 mm placed on sash
- > **Glazing** 4 glasses, safety glass
outside 33.1+4+4+4
- > **Safety cylinder** with five keys
- > **Rosette ring**
- > **3 point** security door locking
system with hooks
- > **Anodised Threshold**
- > **Ud = 0.92 W/m²K**

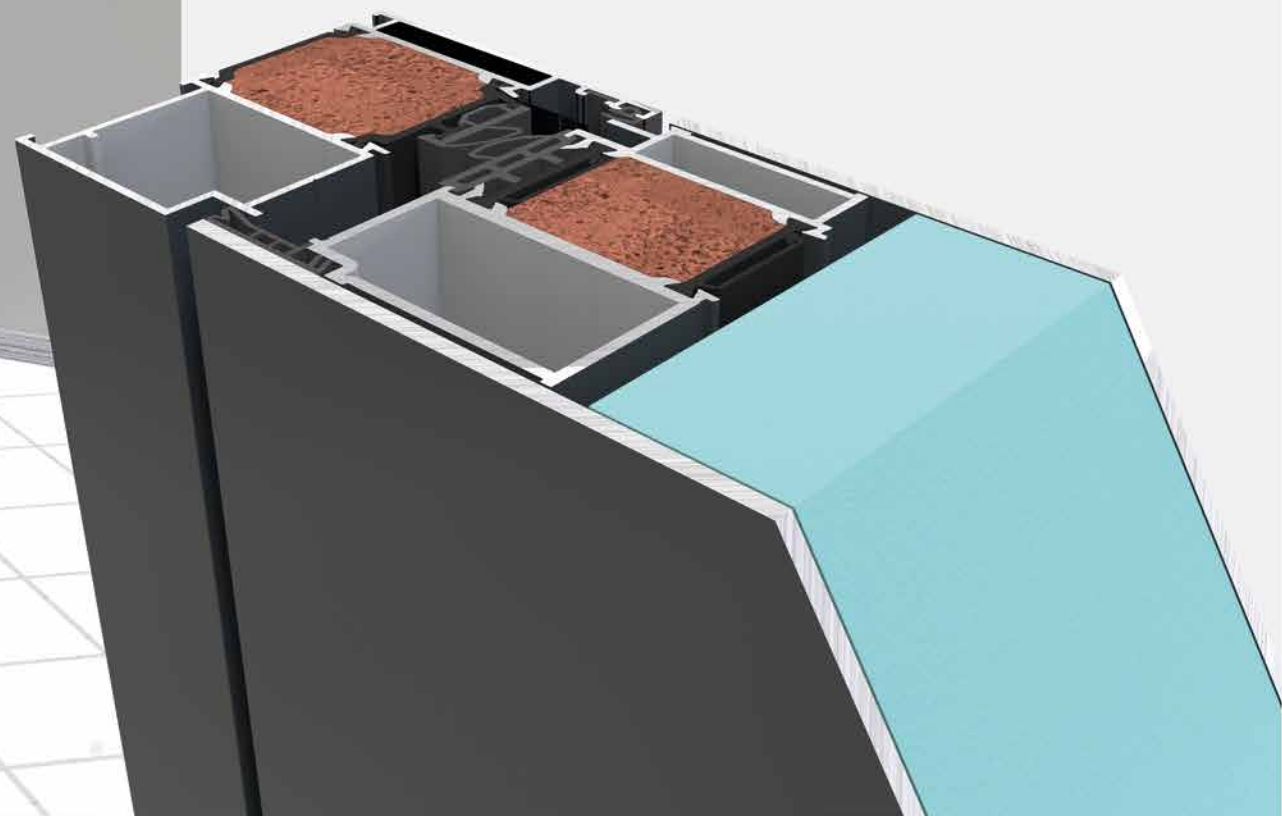

AVANTAGE LINE

STANDARD EQUIPMENT



4 glasses, safety glass
outside 33.1+4+4+4



Safety cylinder
EX-200



Round rosette
EX-900



3D Hinge
EX-301



Inside Handle ID-20
EX-500



OUTSIDE HANDLE 800MM
V175.30.800



3 point hooklock

EX-100

VERTICAL SECTION

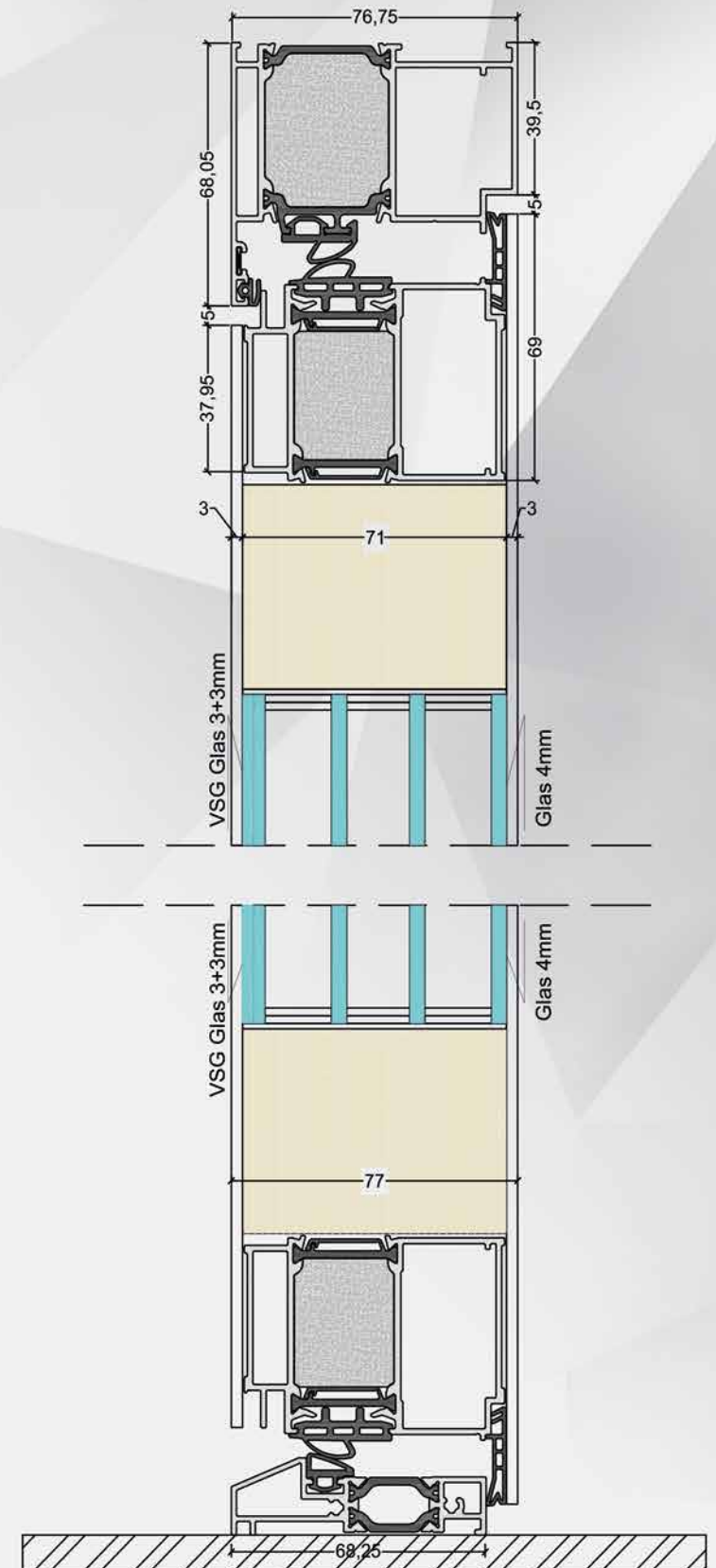

ELEGRANDLINE





ELEGRANDLINE

As flat as curved!

When architecture demands it!!!

ELEGRAND
LINE





Vo101
ELEGRAND | AVANTAGE LINE

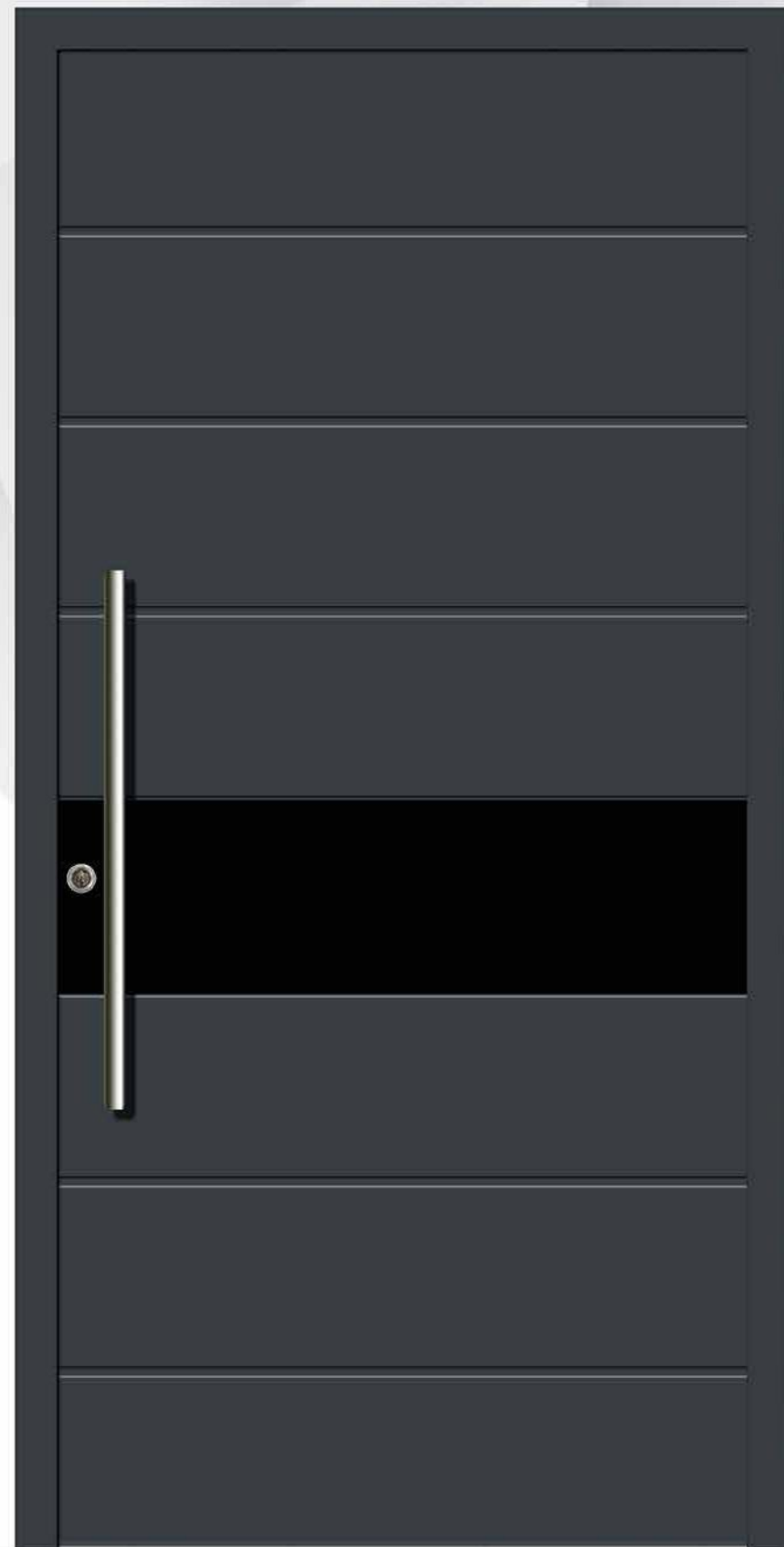

Vo102
ELEGRAND | AVANTAGE LINE

ELEGRAND LINE



Vo130

ELEGRAND | AVANTAGE
COMPACT | ECO LINE



Vo151

ELEGRAND | AVANTAGE LINE



Vo171

ELEGRAND | AVANTAGE LINE



VO172

ELEGRAND | AVANTAGE LINE



ELEGRAND
LINE



V1630
ELEGRAND | AVANTAGE
COMPACT | ECO LINE



VO210
ELEGRAND | AVANTAGE | COMPACT LINE



VO221
ELEGRAND | AVANTAGE LINE

ELEGRAND
LINE

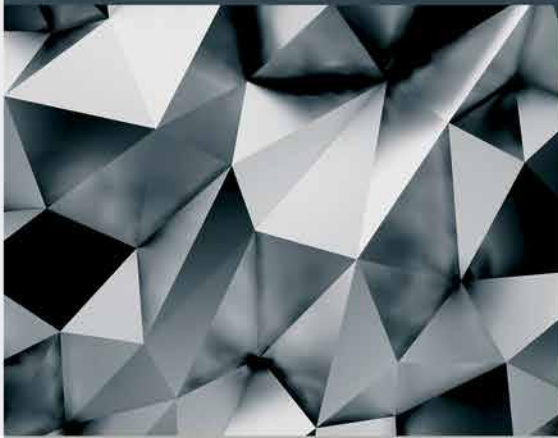

VO230
ELEGRAND | AVANTAGE LINE



VO250
ELEGRAND | AVANTAGE LINE



VO251
ELEGRAND | AVANTAGE LINE



VO260
ELEGRAND | AVANTAGE LINE

ELEGRAND LINE



Vo281
ELEGRAND | AVANTAGE LINE



Vo302
ELEGRAND | AVANTAGE LINE

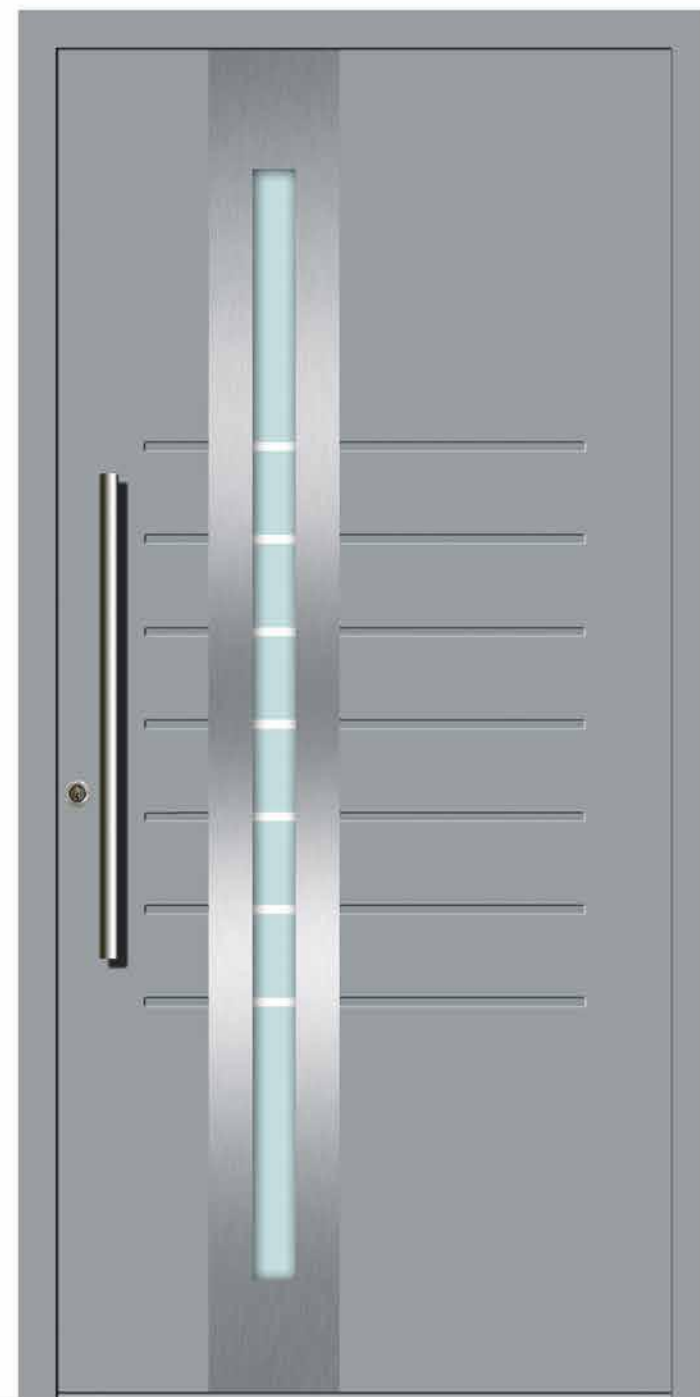

Vo320
ELEGRAND | AVANTAGE LINE



VO330
ELEGRAND | AVANTAGE LINE

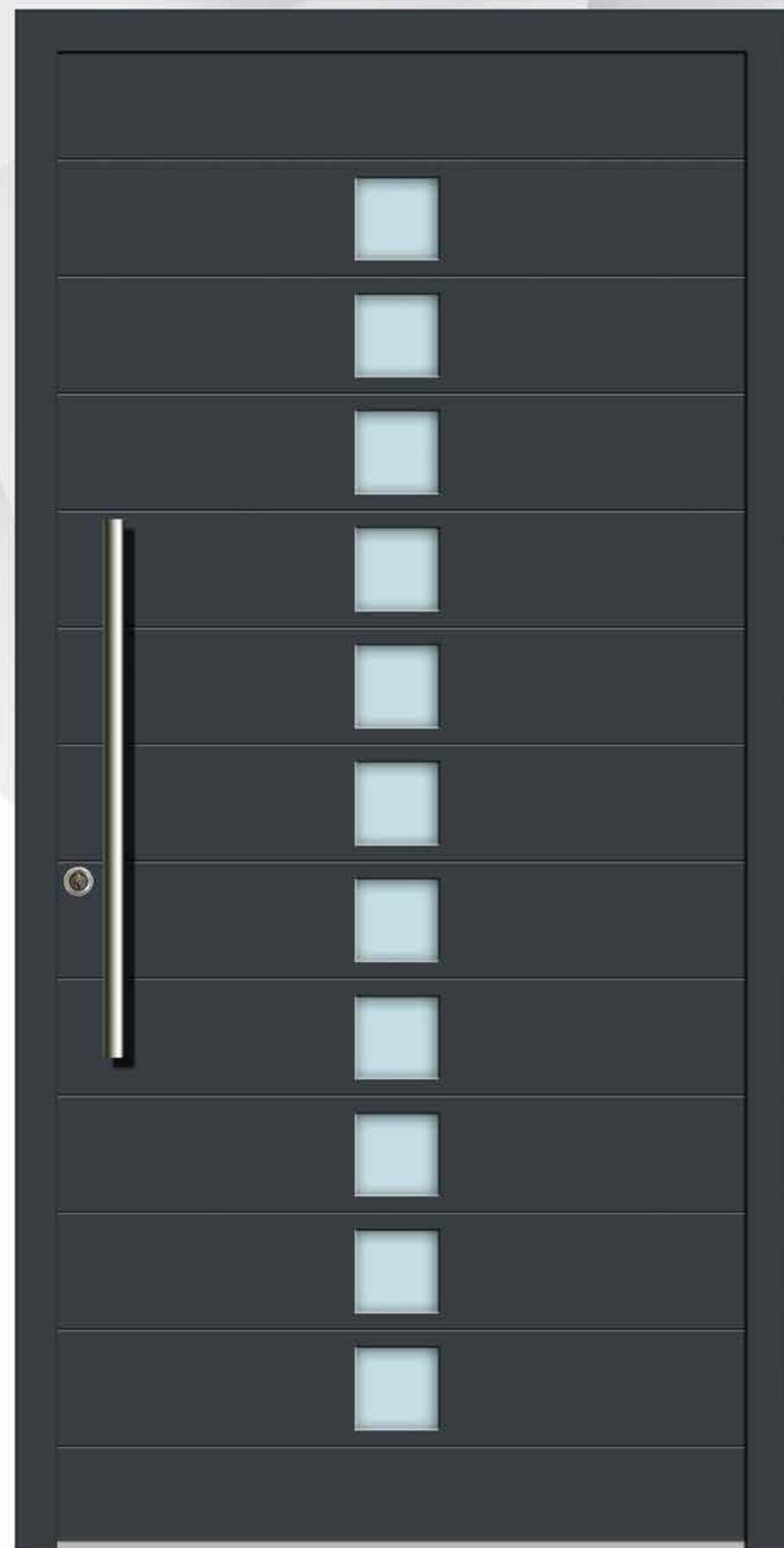

VO350
ELEGRAND | AVANTAGE LINE

ELEGRAND LINE

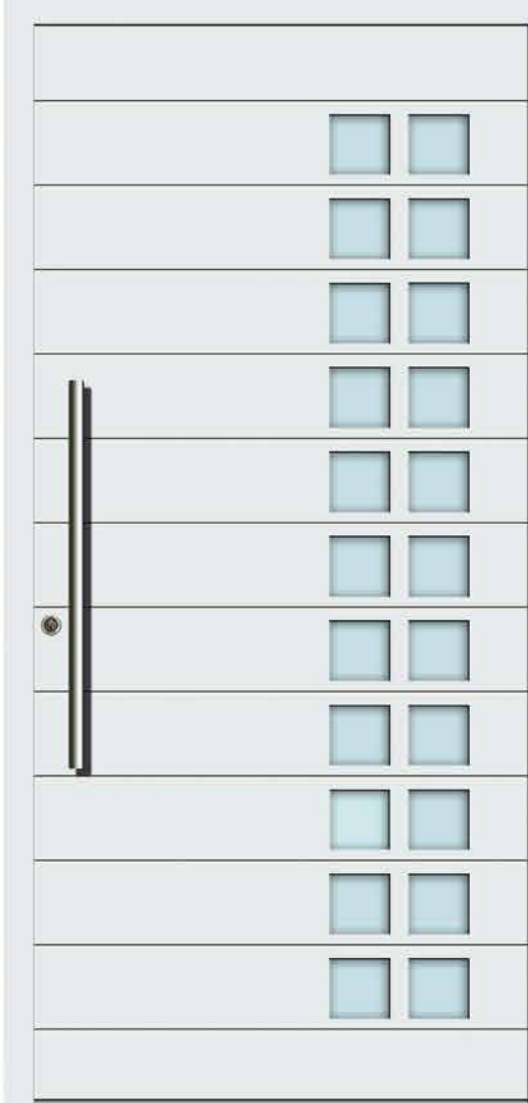
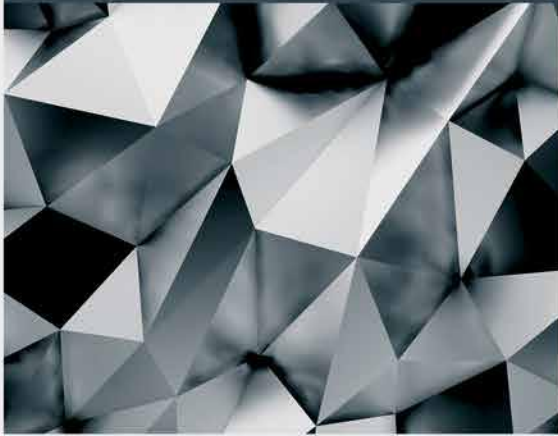

VO351
ELEGRAND | AVANTAGE LINE



VO361
ELEGRAND | AVANTAGE LINE



VO391
ELEGRAND | AVANTAGE LINE



VO411

ELEGRAND | AVANTAGE LINE



ELEGRAND
LINE

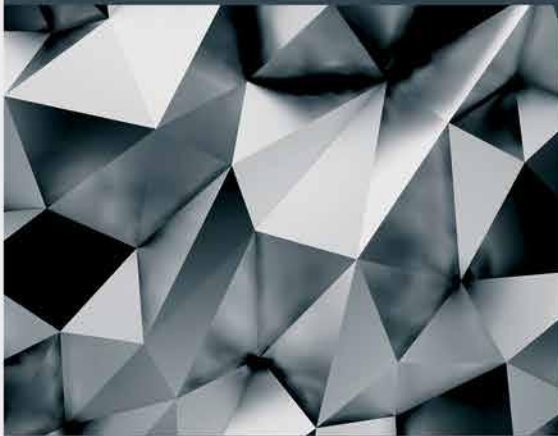

V1250
ELEGRAND | AVANTAGE LINE



VO431
ELEGRAND | AVANTAGE LINE



VO491
ELEGRAND | AVANTAGE LINE



VO550
ELEGRAND | AVANTAGE LINE

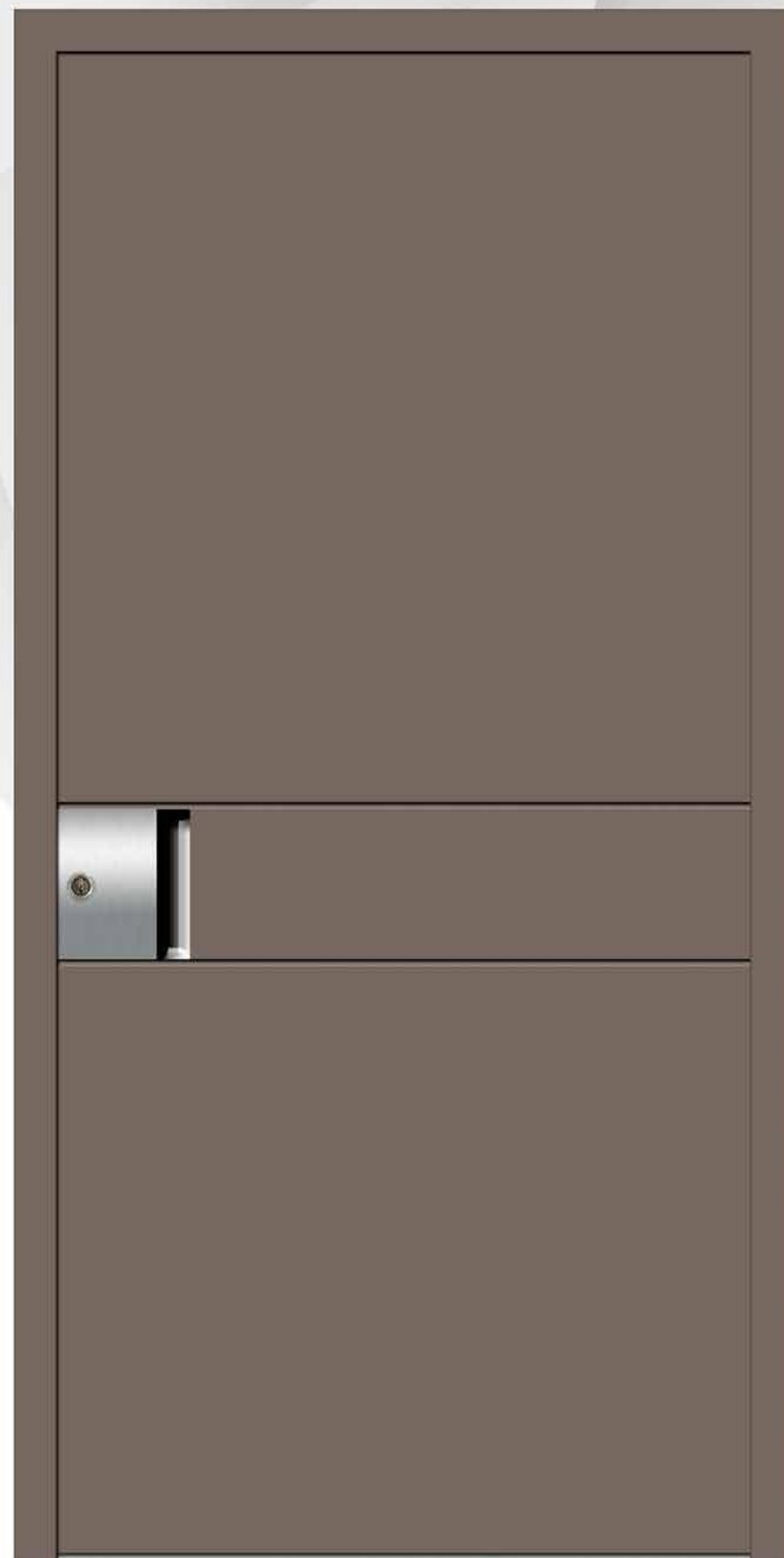

V1240
ELEGRAND | AVANTAGE LINE

ELEGRAND
LINE

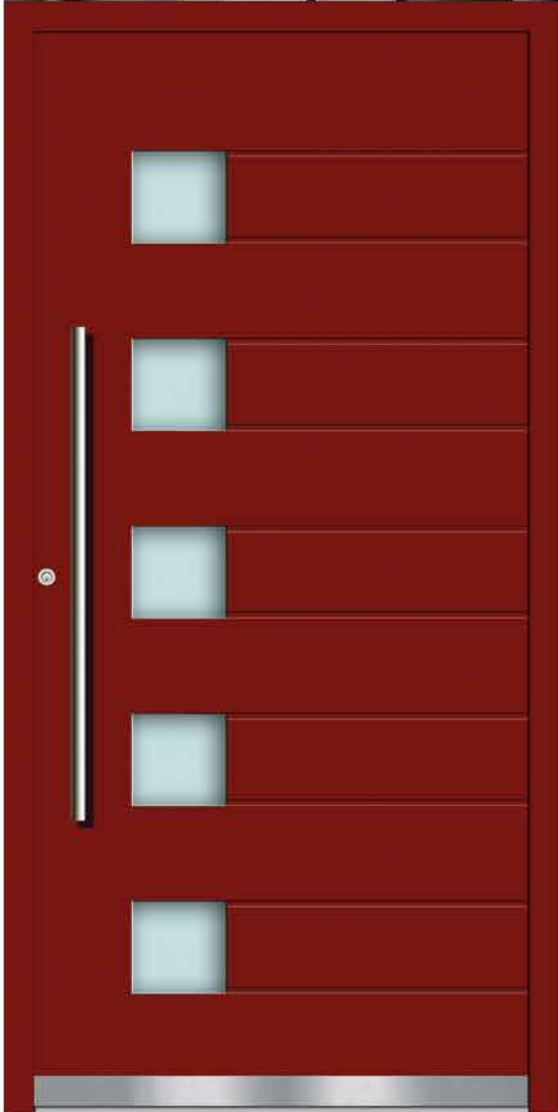

VO270
ELEGRAND | AVANTAGE LINE

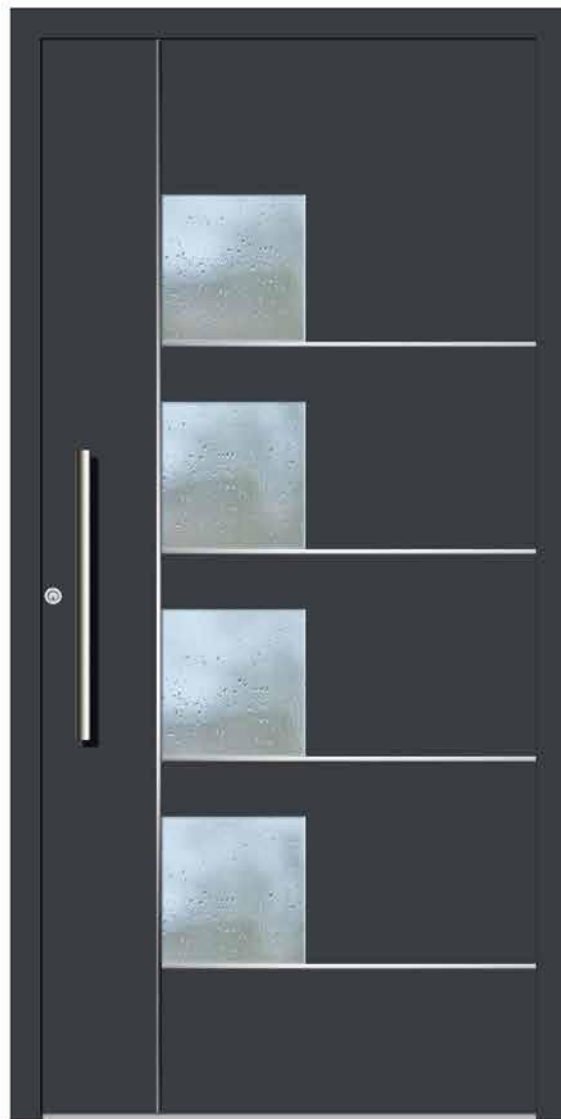

VO510
ELEGRAND | AVANTAGE LINE



V1420
ELEGRAND | AVANTAGE LINE



V1500
ELEGRAND | AVANTAGE LINE

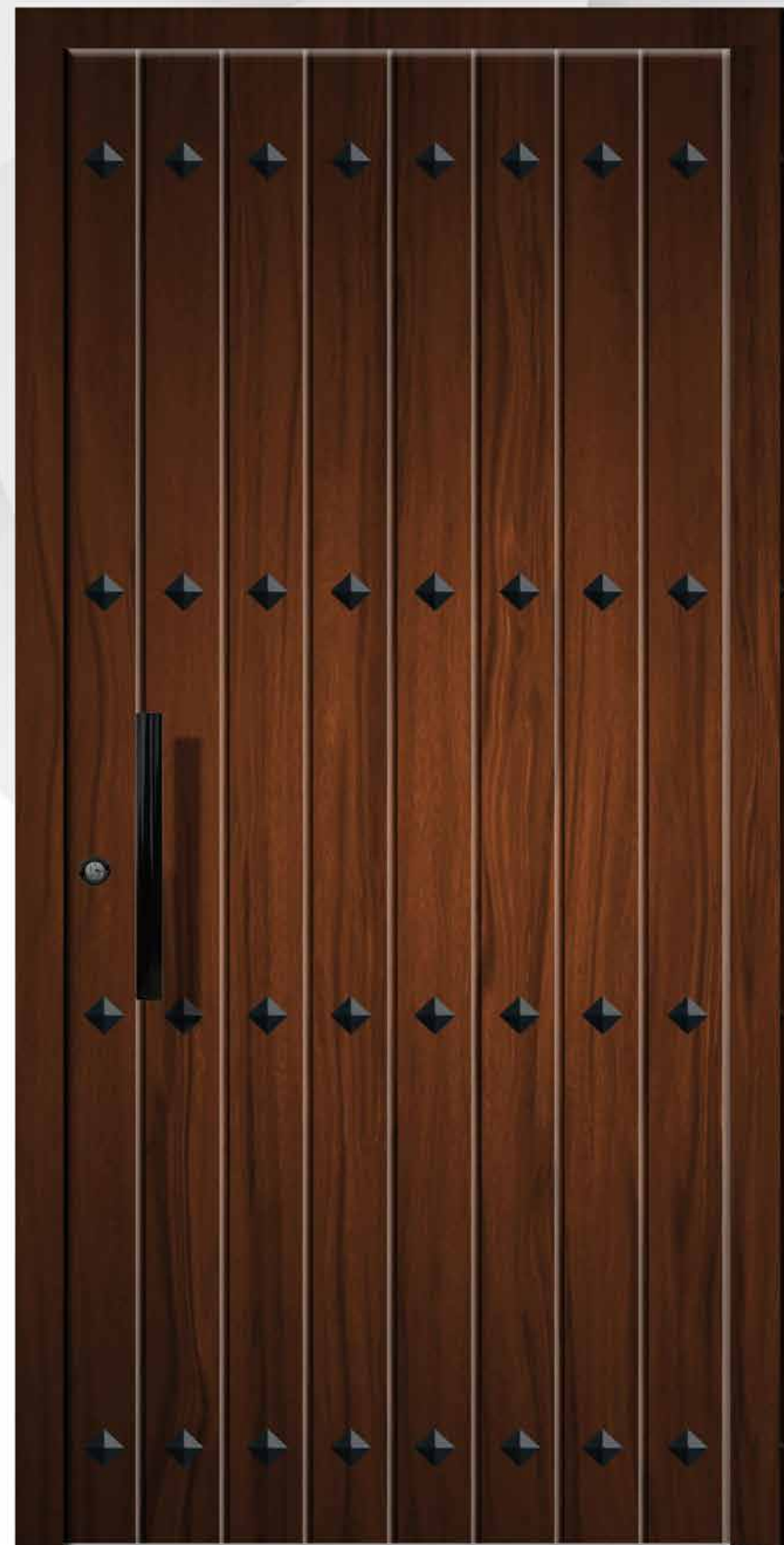

Vo580
ELEGRAND | AVANTAGE LINE

ELEGRAND
LINE



V1260
ELEGRAND | AVANTAGE LINE



V1270
ELEGRAND | AVANTAGE LINE



V1280
ELEGRAND | AVANTAGE LINE



VERPAN

PREMIUM DESIGN

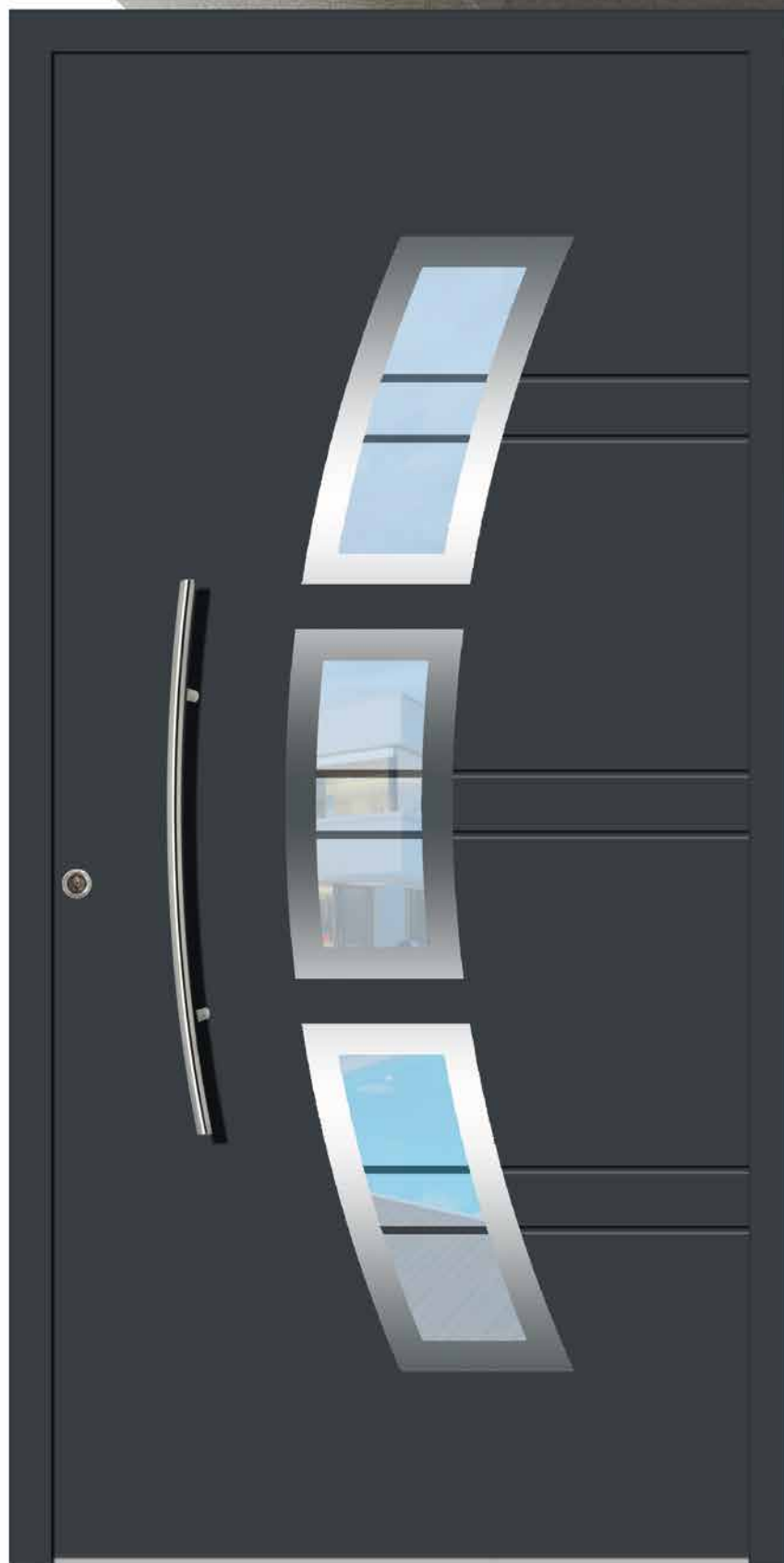

V1310

ELEGRAND | AVANTAGE LINE

VERPAN | ELEGANT TRADITIONALLINE

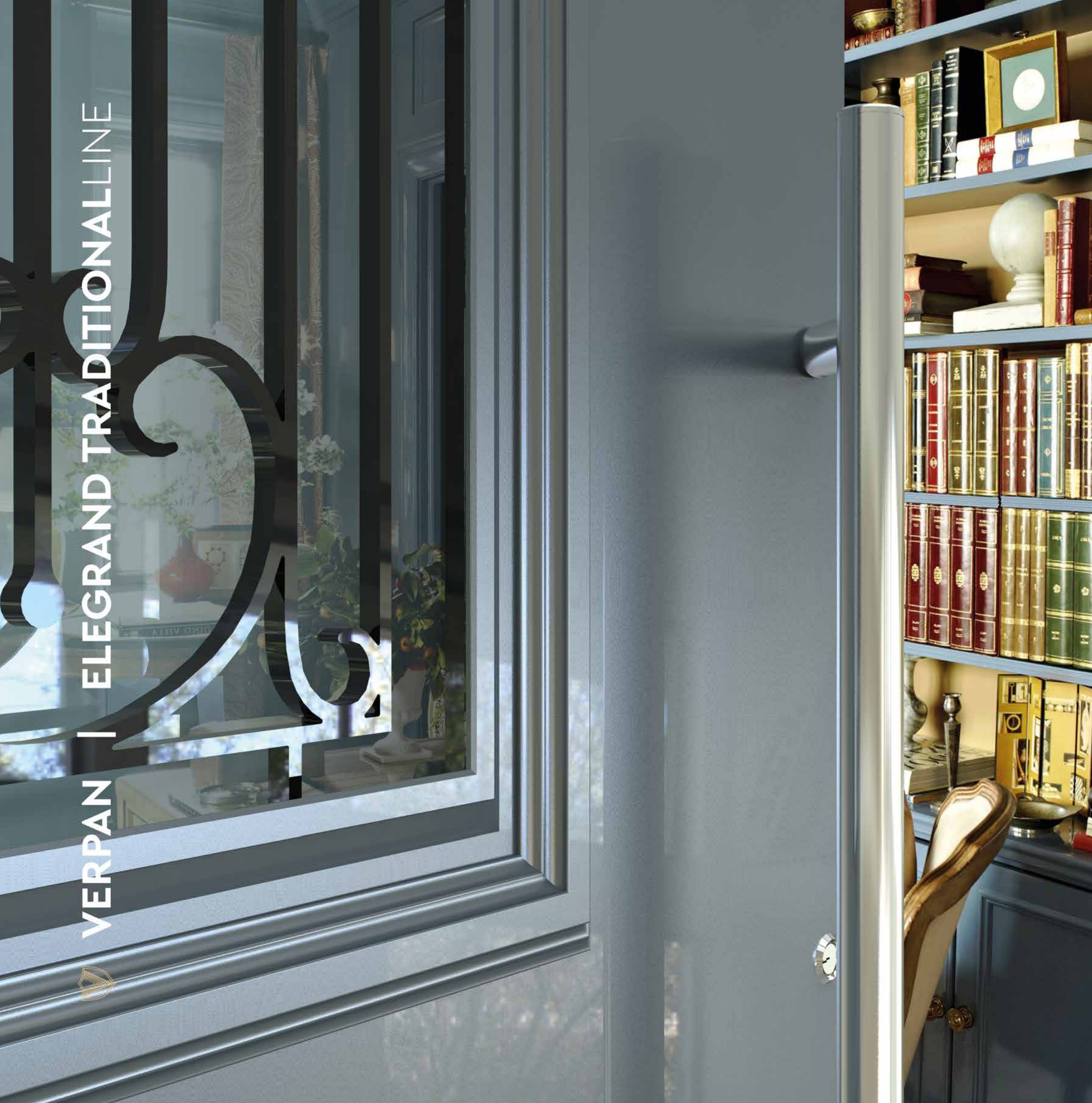



ELEGRAND TRADITIONALLINE

Your romantic traditional home
needs an everlasting beauty!!!

Traditional Handmade Entrance door to last through time.

ELEGRAND
TRADITIONALLINE

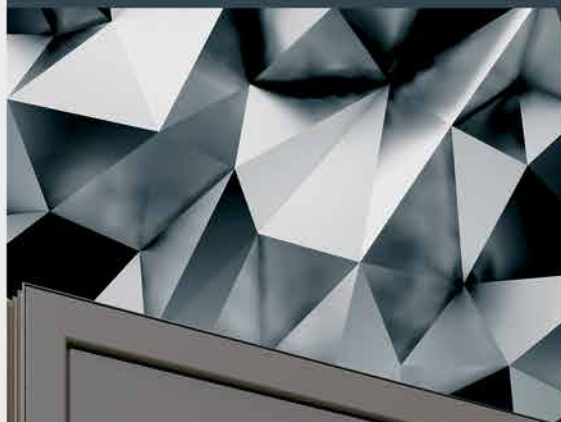

V1030
ELEGRAND | AVANTAGE LINE



V1031
ELEGRAND | AVANTAGE LINE



V1060
ELEGRAND | AVANTAGE LINE



V1063
ELEGAND | AVANTAGE LINE



ELEGRAND
TRADITIONALLINE



V1100
ELEGRAND | AVANTAGE LINE



V0530
ELEGRAND | AVANTAGE LINE



V0534
ELEGRAND | AVANTAGE LINE



V1101
ELEGRAND | AVANTAGE LINE



ELEGRANDLINE

STANDARD EQUIPMENT

Both - sided sash overlapping panel 78.2mm. Aluminium thickness 2mm and 1mm. Inox ornaments on the same level with alu sheets.

- > **3 hinges** 2D
- > **Inside handle** Inox ID-20
- > **Outside Handle Round**
inox 800 mm placed on sash
- > **Glazing** 3 glasses, 4+4+4
- > **Simple cylinder** with three keys
- > **Rosette ring**
- > **3 point** security door locking system with hooks
- > **Anodised Threshold**
- > **Ud = 0.98 W/m²K**

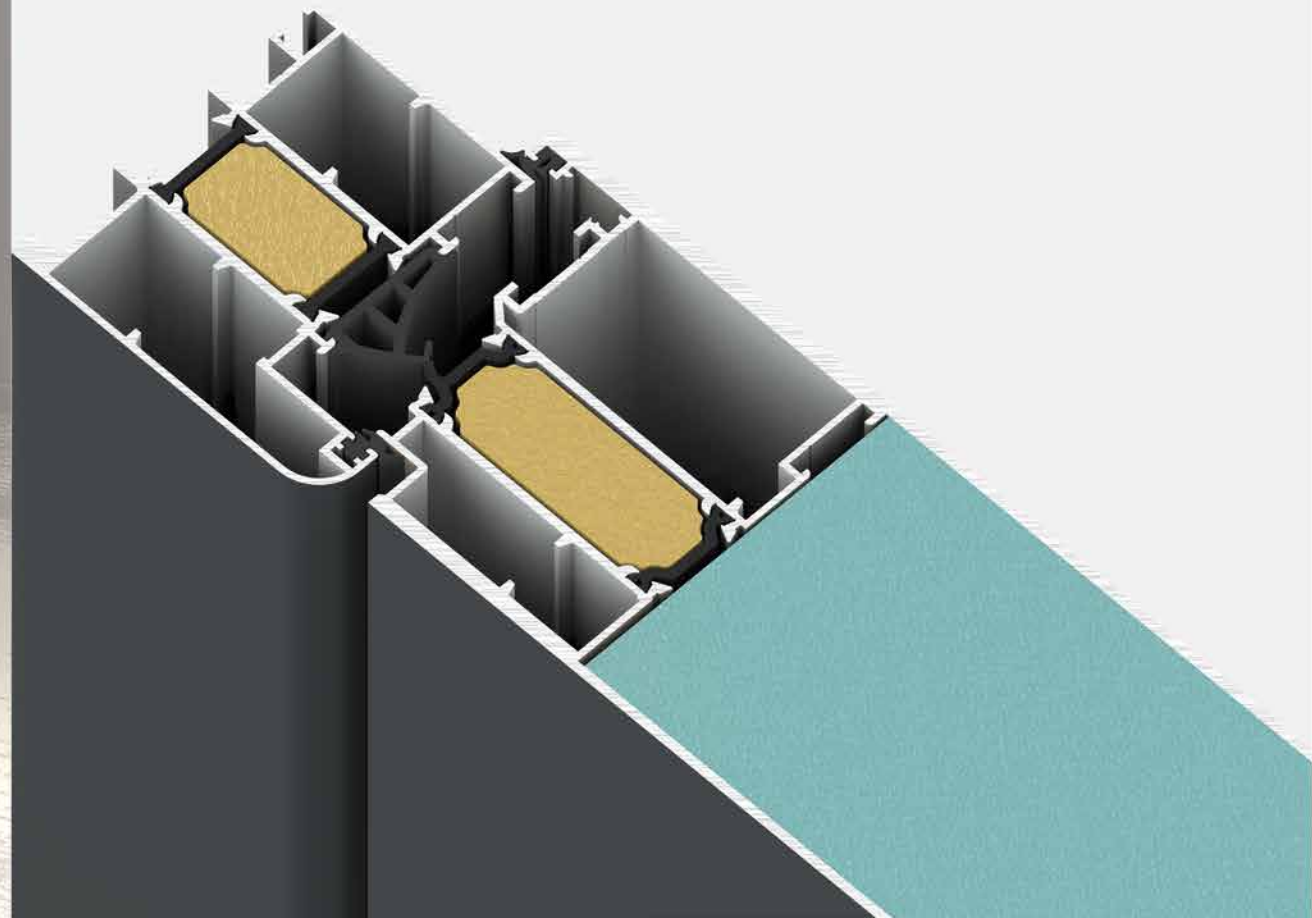

STANDARD EQUIPMENT



3 glasses 4+4+4



Simple cylinder
EX-206



Round rosette
EX-900



2D Hinge
EX-305



Inside Handle ID-20
EX-500



OUTSIDE HANDLE 800MM
V175.30.800

3 point hooklock

EX-100

VERTICAL SECTION

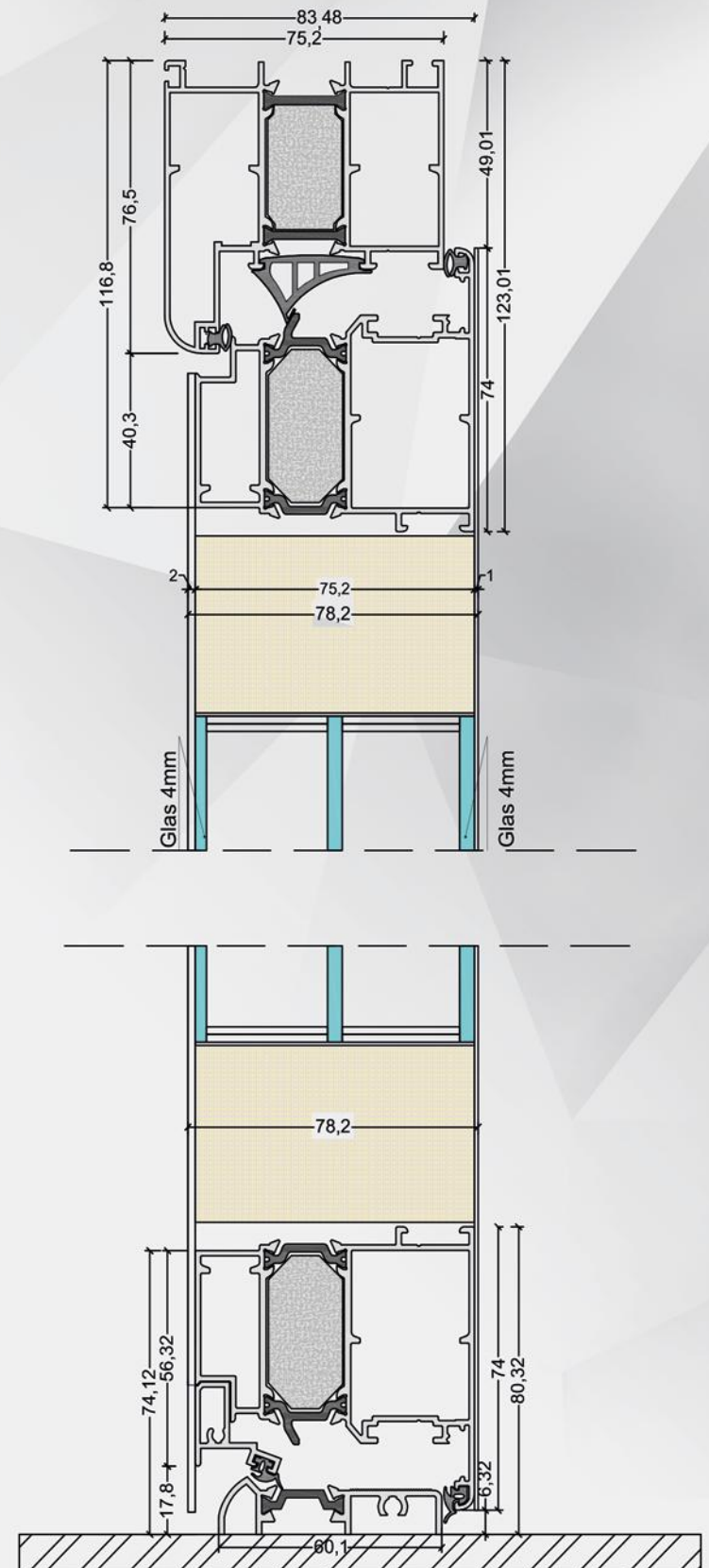

VERPAN | COMPACTLINE



A vertical strip on the left side of the page shows a wood grain texture with wavy, horizontal lines in shades of light brown and tan. The rest of the page is solid black.

COMPACTLINE

A solution for you!

Simple and beautiful!!!

COMPACT
LINE





Vo100
COMPACT | AVANTAGE
ELEGRAND LINE



Vo110
COMPACT | AVANTAGE
ELEGRAND LINE

COMPACT
LINE



Vo111
COMPACT | AVANTAGE
ELEGRAND | ECO LINE



Vo131
COMPACT
AVANTAGE | ECO LINE



Vo160
COMPACT | ELEGRAND LINE

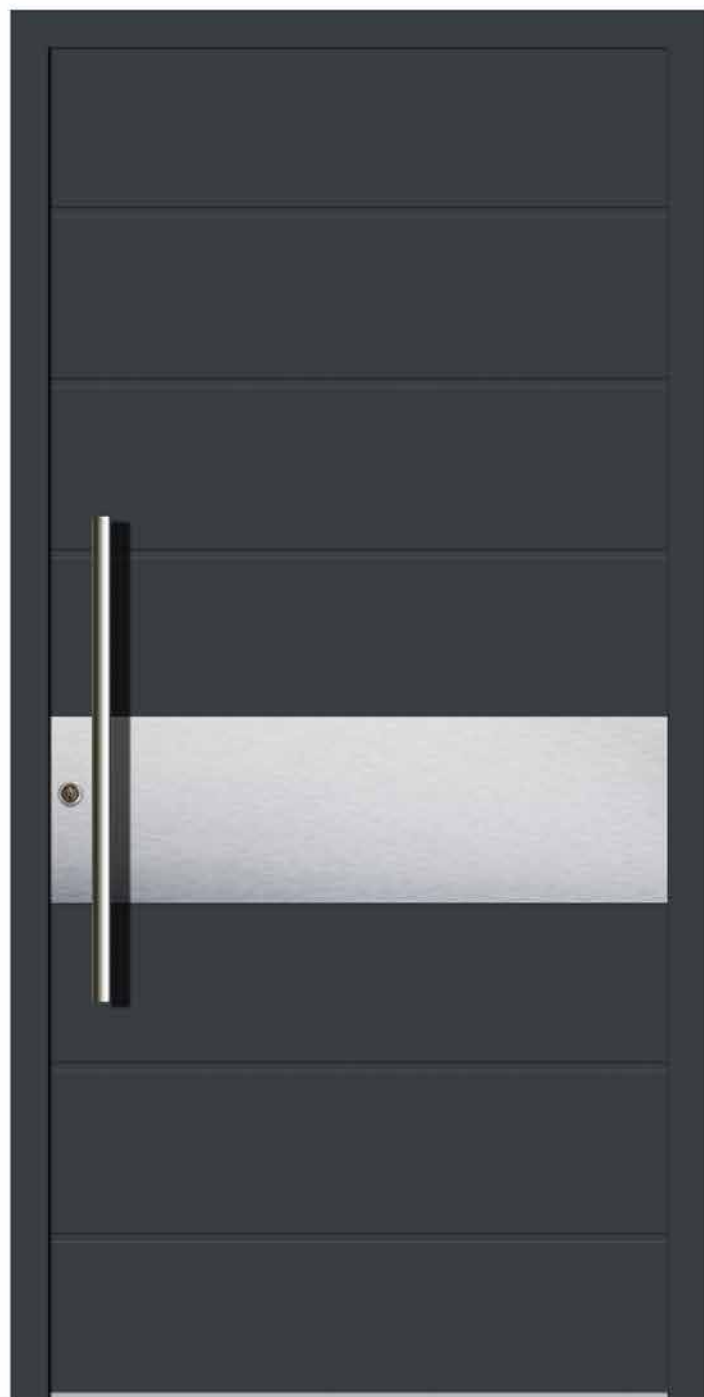

VO101

COMPACT | ELEGRAND LINE



COMPACT
LINE



Vo190
COMPACT | AVANTAGE
ELEGRAND LINE



VO200
COMPACT | AVANTAGE
ELEGRAND | ECO LINE

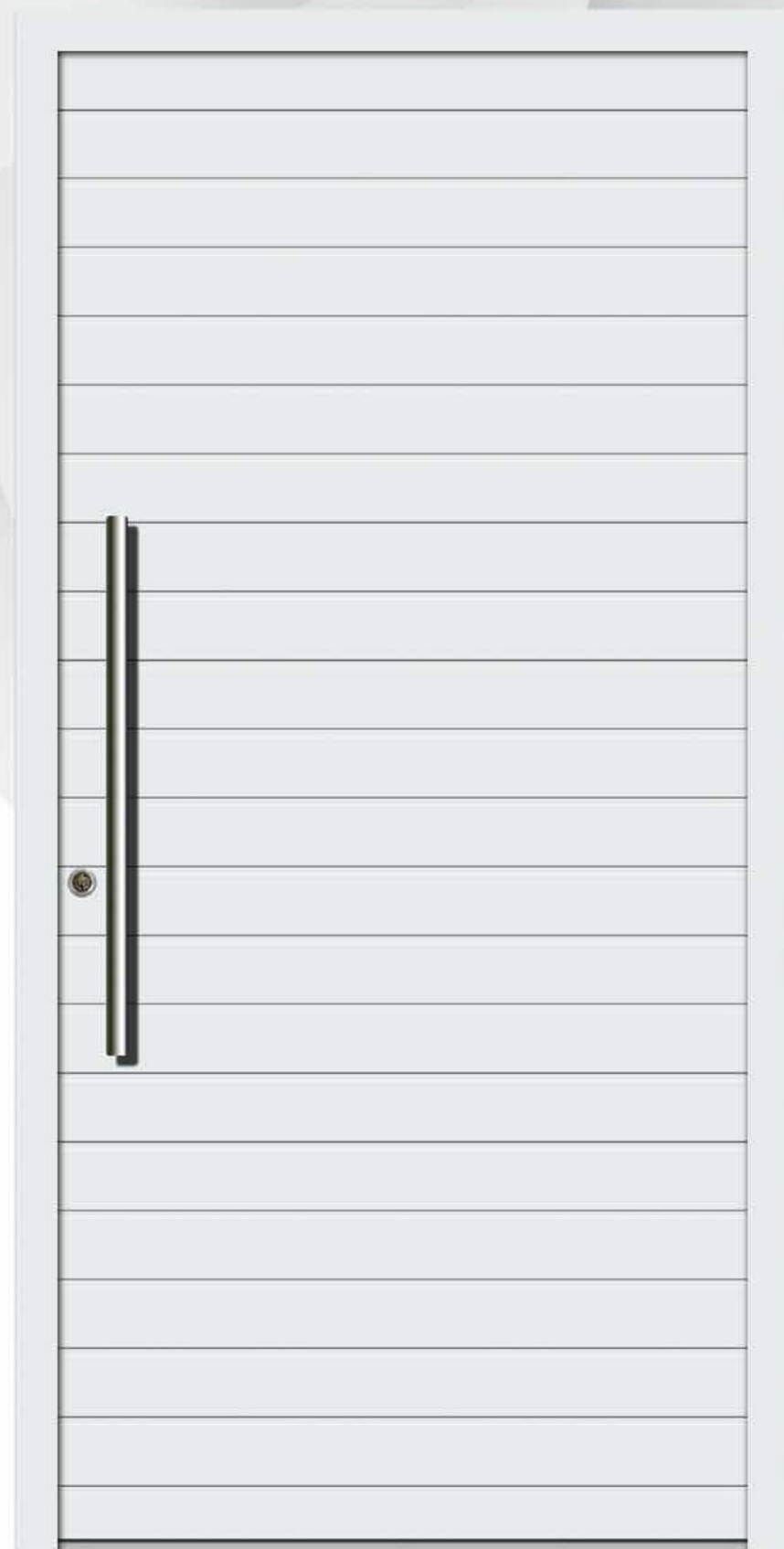

VO222
COMPACT | ELEGRAND LINE

COMPACT LINE

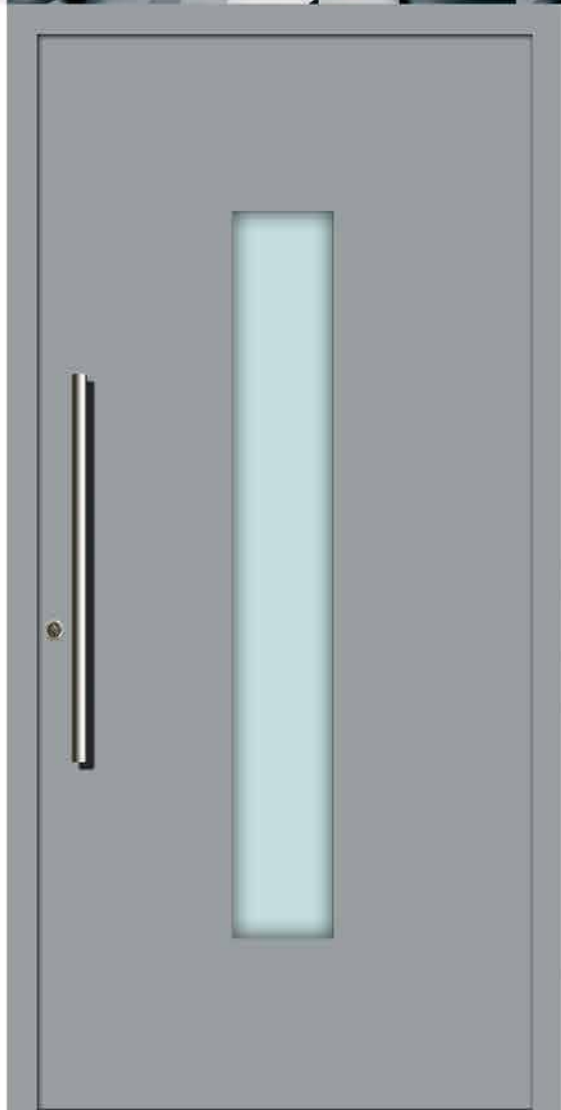

Vo261
COMPACT | ELEGRAND LINE



Vo280
COMPACT
ELEGRAND | ECO LINE



Vo392
COMPACT | AVANTAGE
ELEGRAND LINE

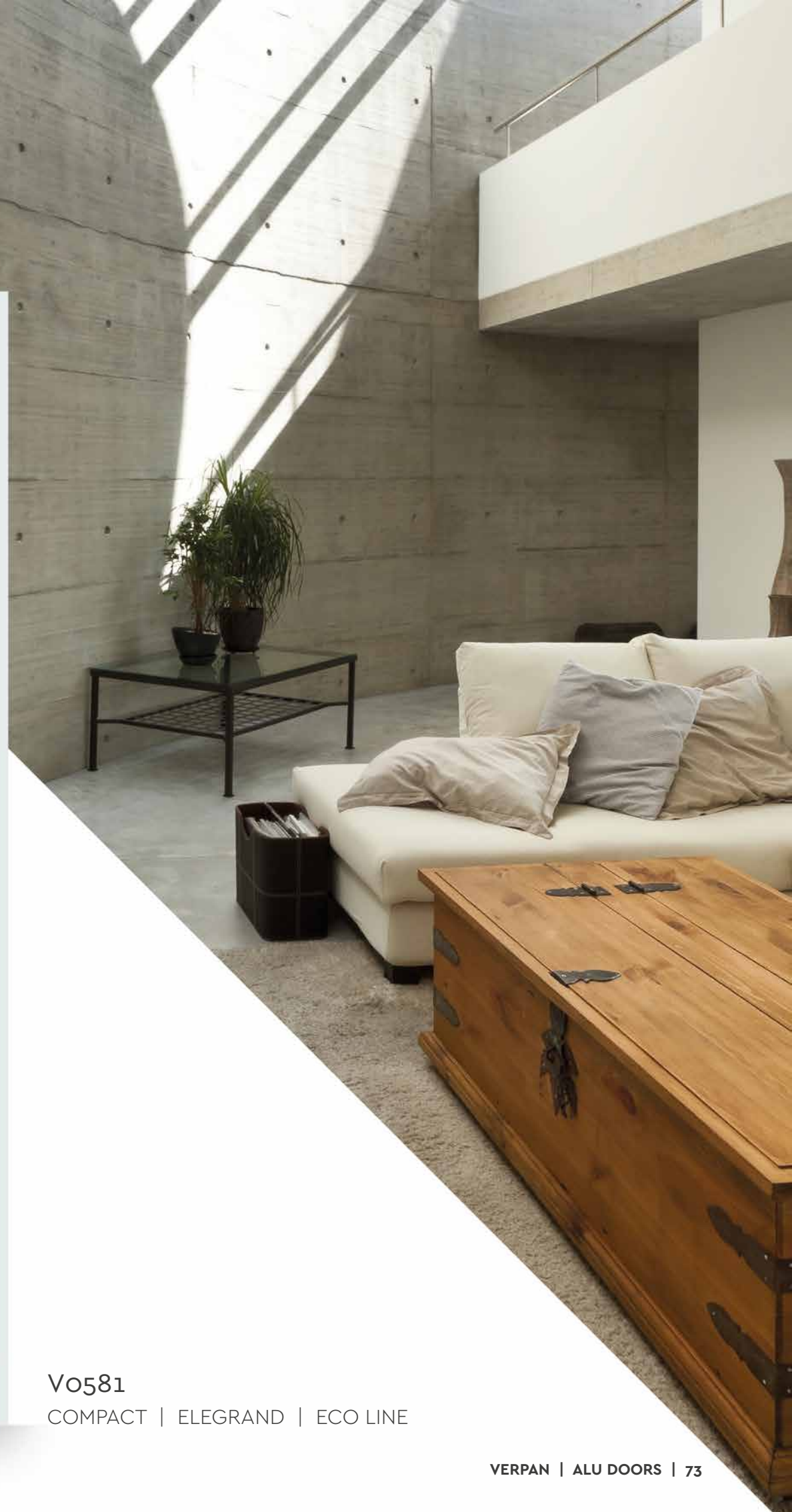

VO581
COMPACT | ELEGRAND | ECO LINE

COMPACT
LINE



V1340

COMPACT | ELEGRAND | ECO LINE



V1380
COMPACT | ELEGRAND LINE

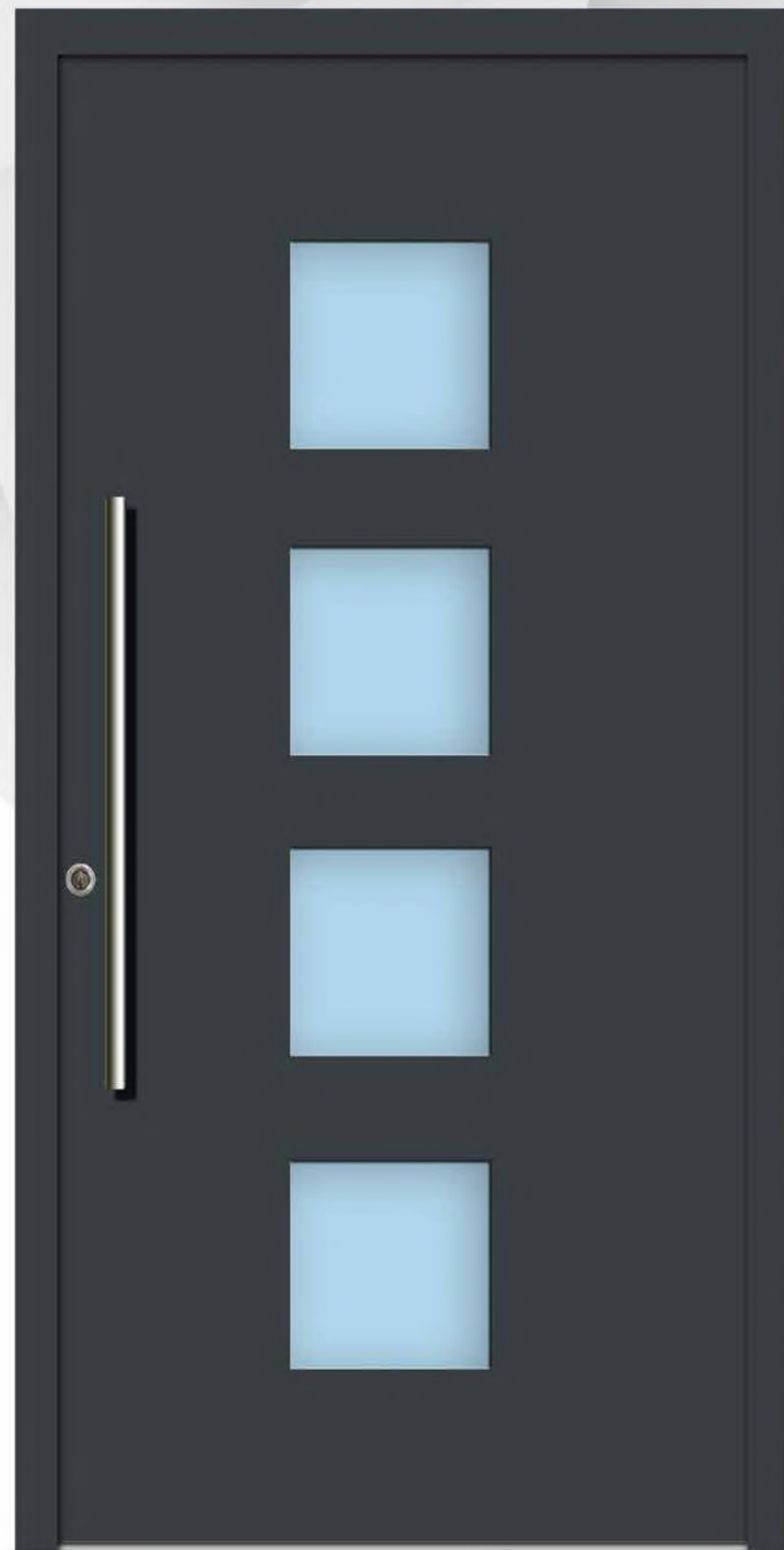

V1430
COMPACT | ELEGRAND LINE

COMPACTLINE

STANDARD EQUIPMENT

Both – sided sash overlapping panel 69.1mm. Aluminium thickness 1.5mm and 1.5mm. Inox ornaments above the level of alu sheets.

- > **3 hinges** 2D
- > **Inside handle** Inox ID-20
- > **Outside Handle Round**
inox 400 mm placed on sash
- > **Glazing** 3 glasses, 4+4+4
- > **Simple cylinder** with three keys
- > **Rosette ring**
- > **1 point** locking system
- > **Anodised Threshold**
- > **Ud = 0.96 W/m²K**

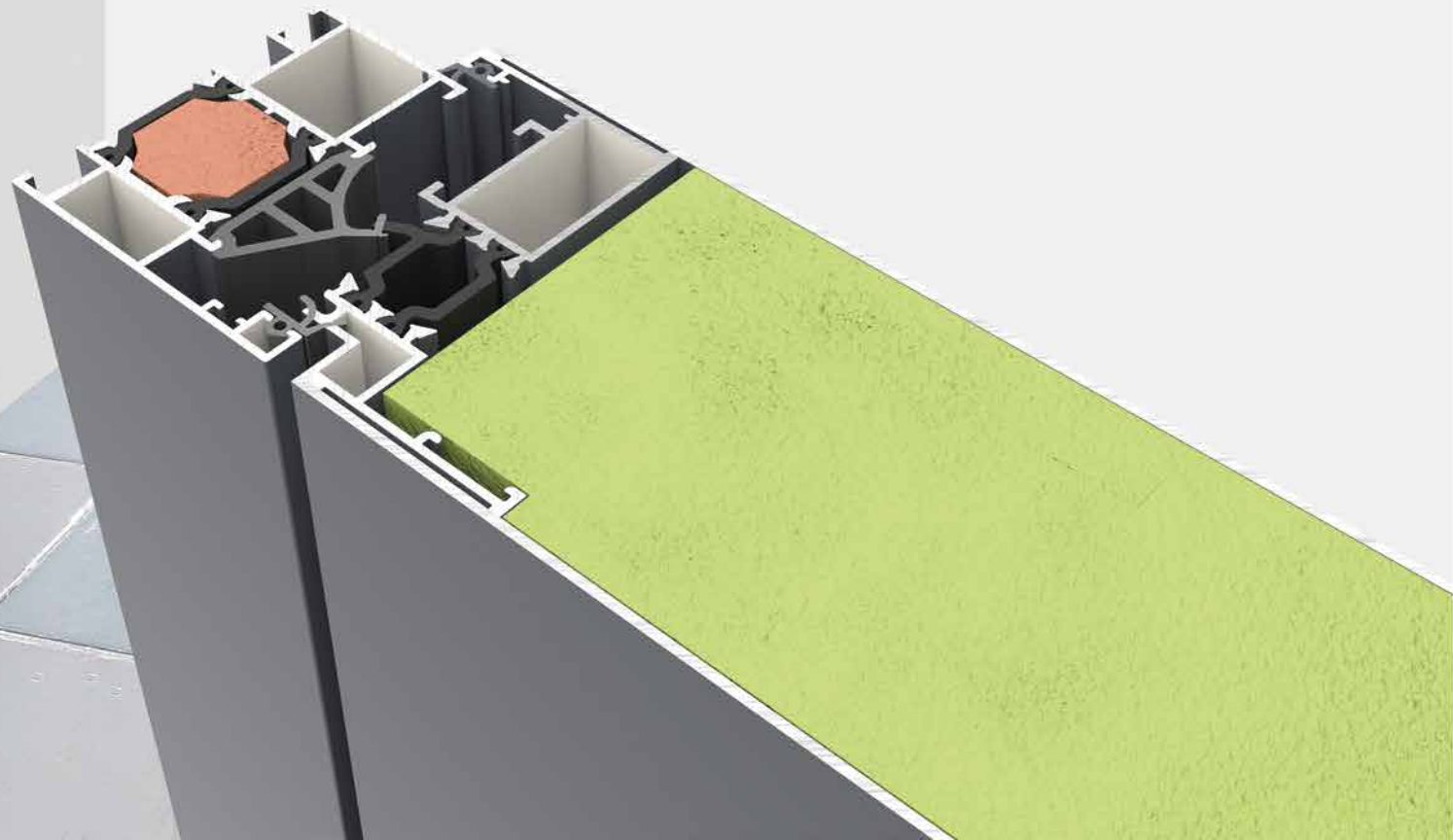

COMPACTLINE

STANDARD EQUIPMENT



3 glasses 4+4+4



Simple cylinder
EX-206



Round rosette
EX-900



2D Hinge
EX-306



Inside Handle ID-20
EX-500



1 point lock
EX-107



OUTSIDE HANDLE 400MM
V175.30.400

VERTICAL SECTION

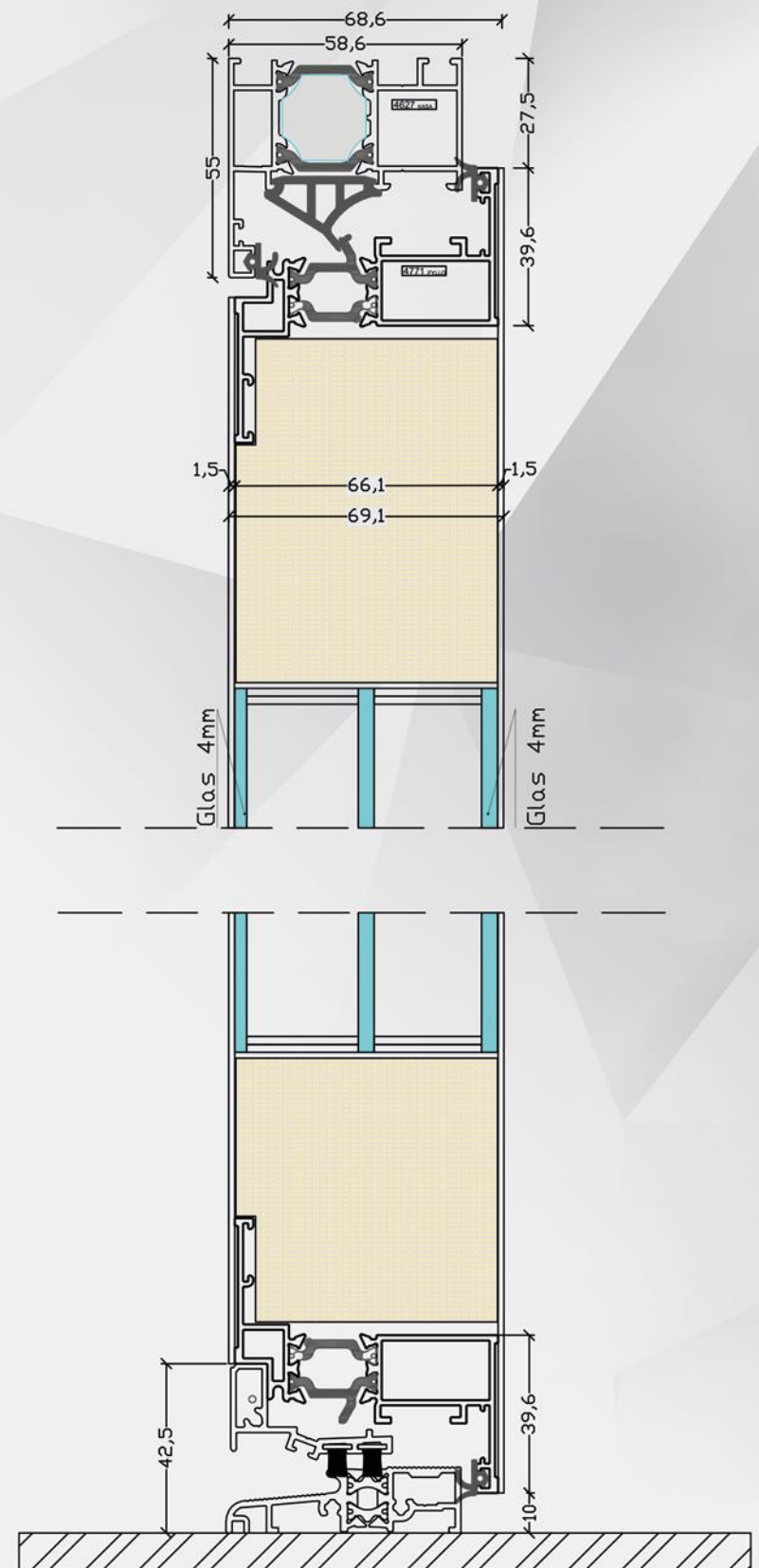

 VERPAN | ECOLINE





ECOLINE

Simple and free of exaggerations!

Simplicity of straight lines.

ECOLINE





VO112

ECO | ELEGRAND | COMPACT LINE

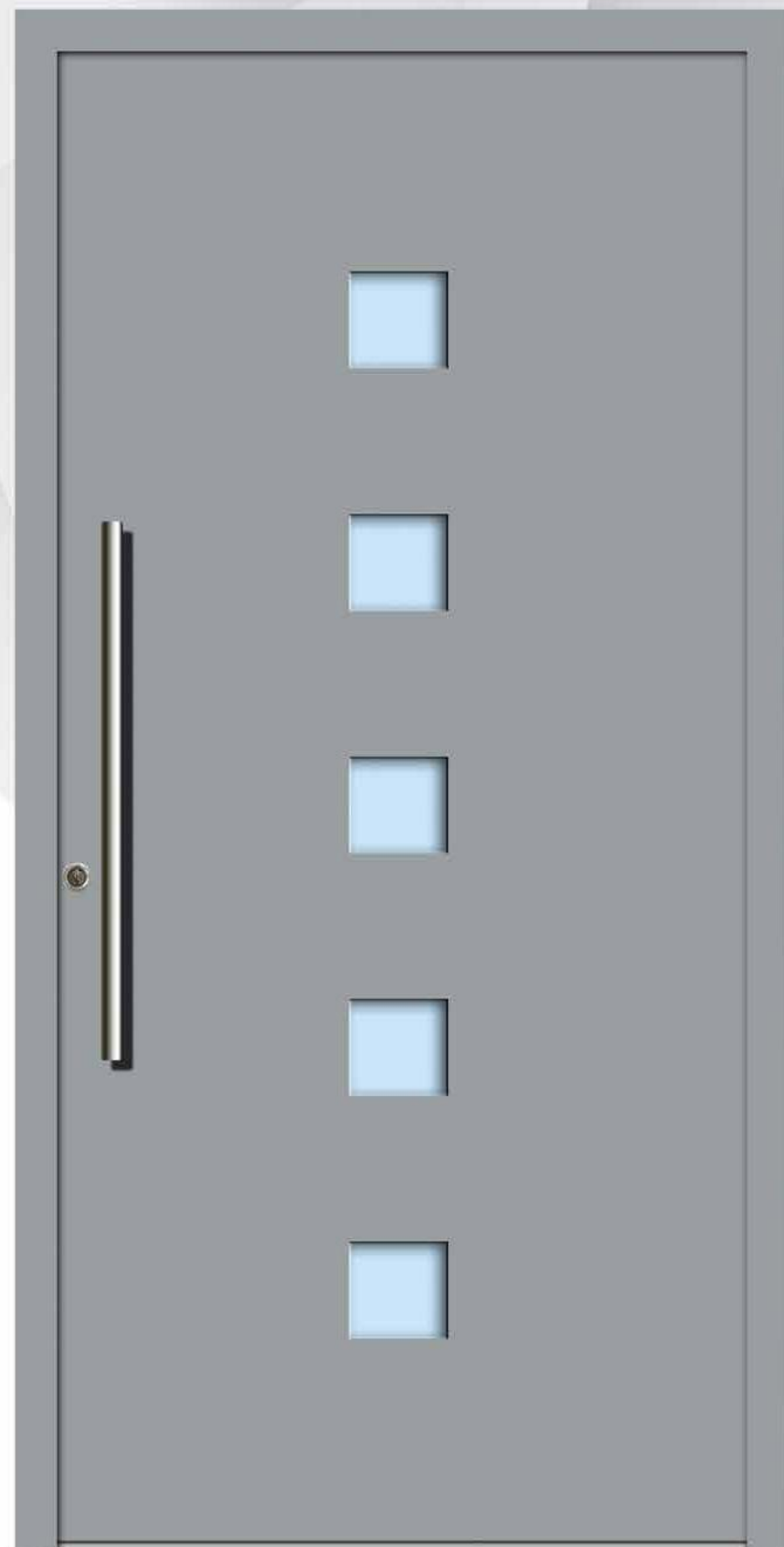

VO144

ECO | ELEGRAND | COMPACT LINE

ECOLINE



Vo130

ECO | AVANTAGE
ELEGRAND | COMPACT LINE



Vo311

ECO | AVANTAGE
ELEGRAND | COMPACT LINE



Vo360

ECO | ELEGRAND | COMPACT LINE

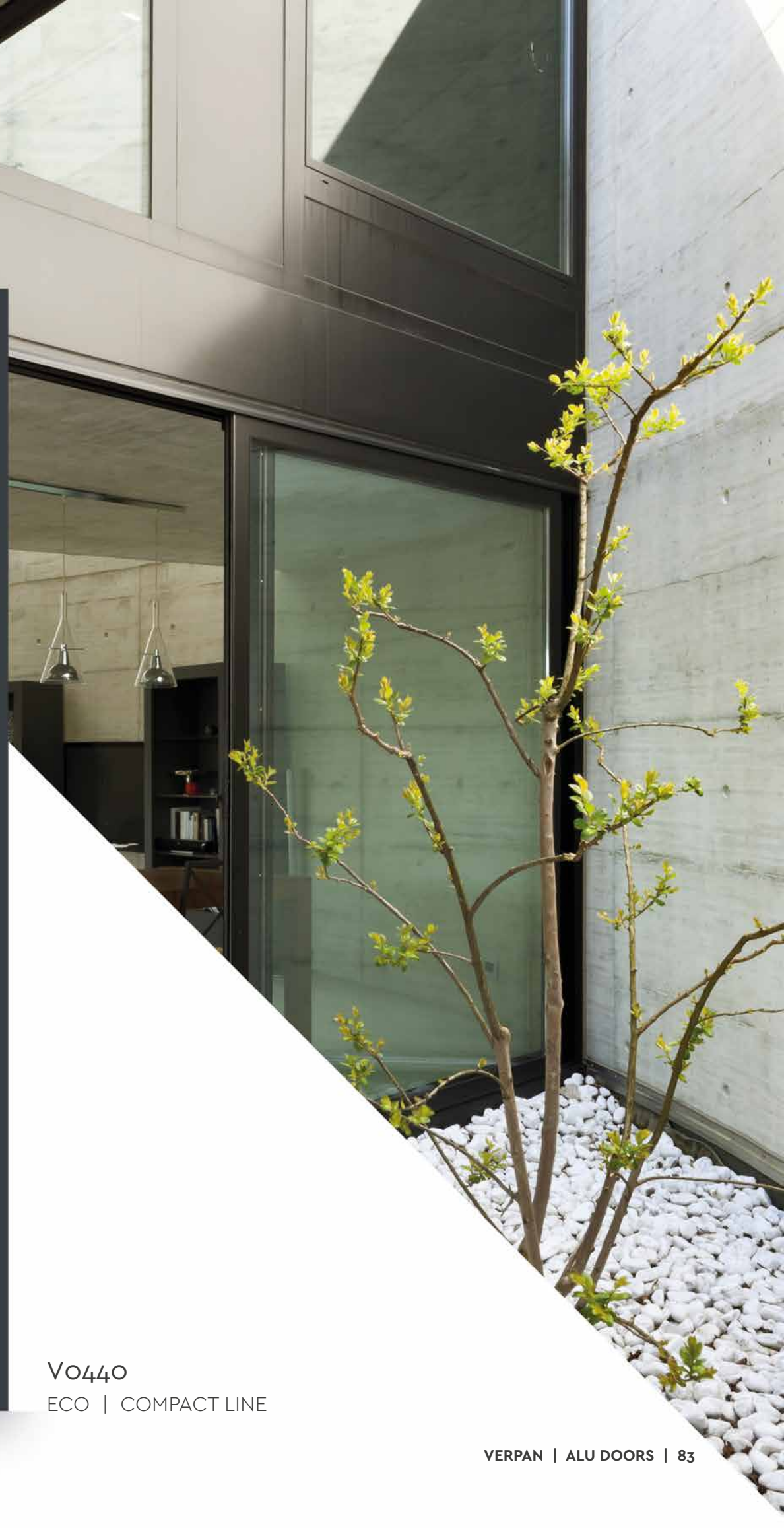

VO440
ECO | COMPACT LINE

ECOLINE

STANDARD EQUIPMENT

Both - sided sash overlapping panel 64.3mm. Aluminium thickness 1.5mm and 1mm. Inox ornaments above the level of alu sheets.

- > **3 hinges**
- > **Inside handle** Inox ID-20
- > **Outside Handle Round**
inox 400 mm placed on sash
- > **Glazing** 3 glasses, 4+4+4
- > **Simple cylinder** with three keys
- > **Rosette**
- > **1 point** locking system
- > **Anodised Threshold**

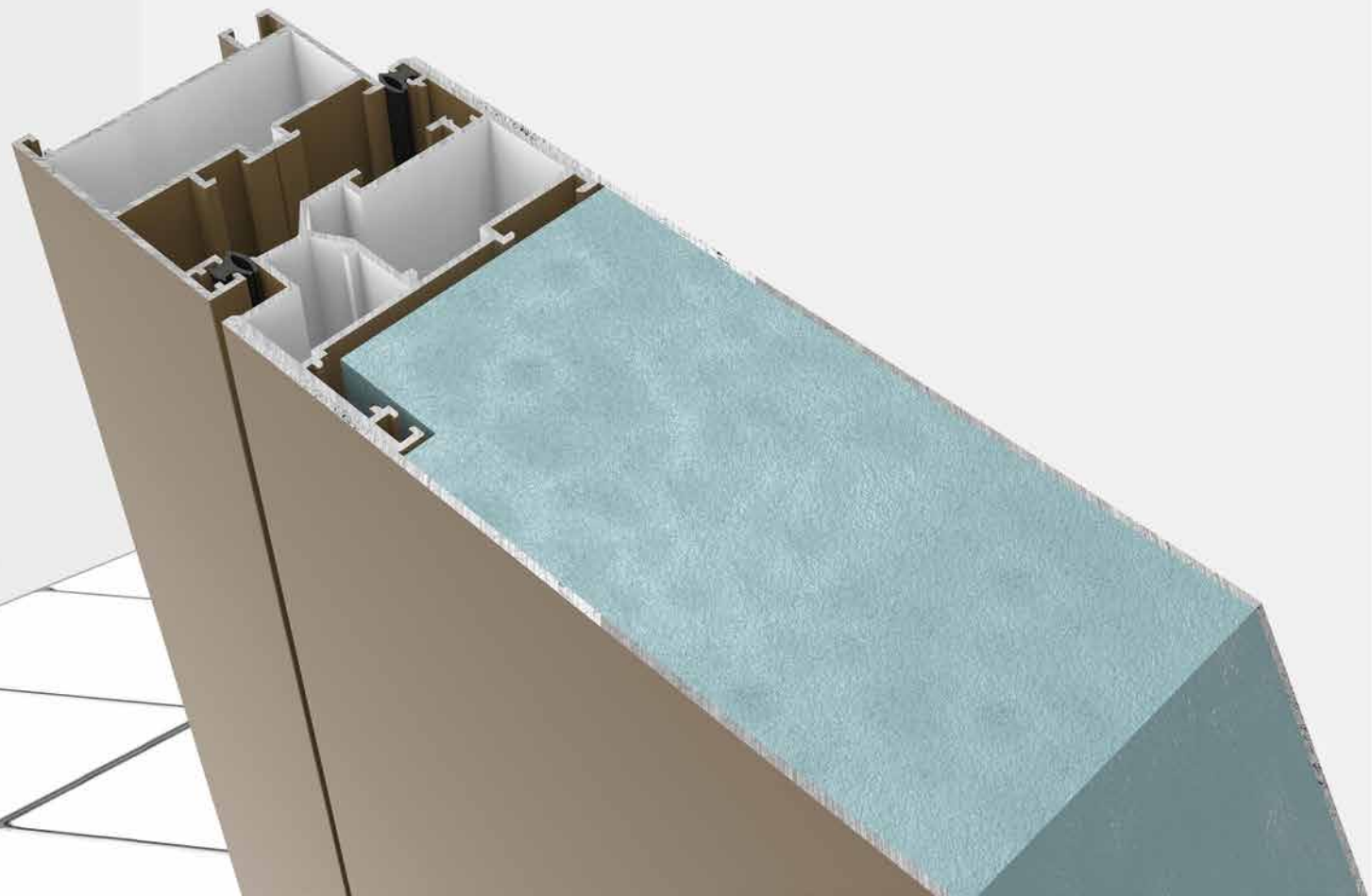



3 glasses 4+4+4



Simple cylinder
EX-206



Round rossette
EX-901



Eco Hinge
EX-307



Inside Handle ID-20
EX-500



1 point lock
EX-107



OUTSIDE HANDLE 400MM
V175.30.400

VERTICAL SECTION

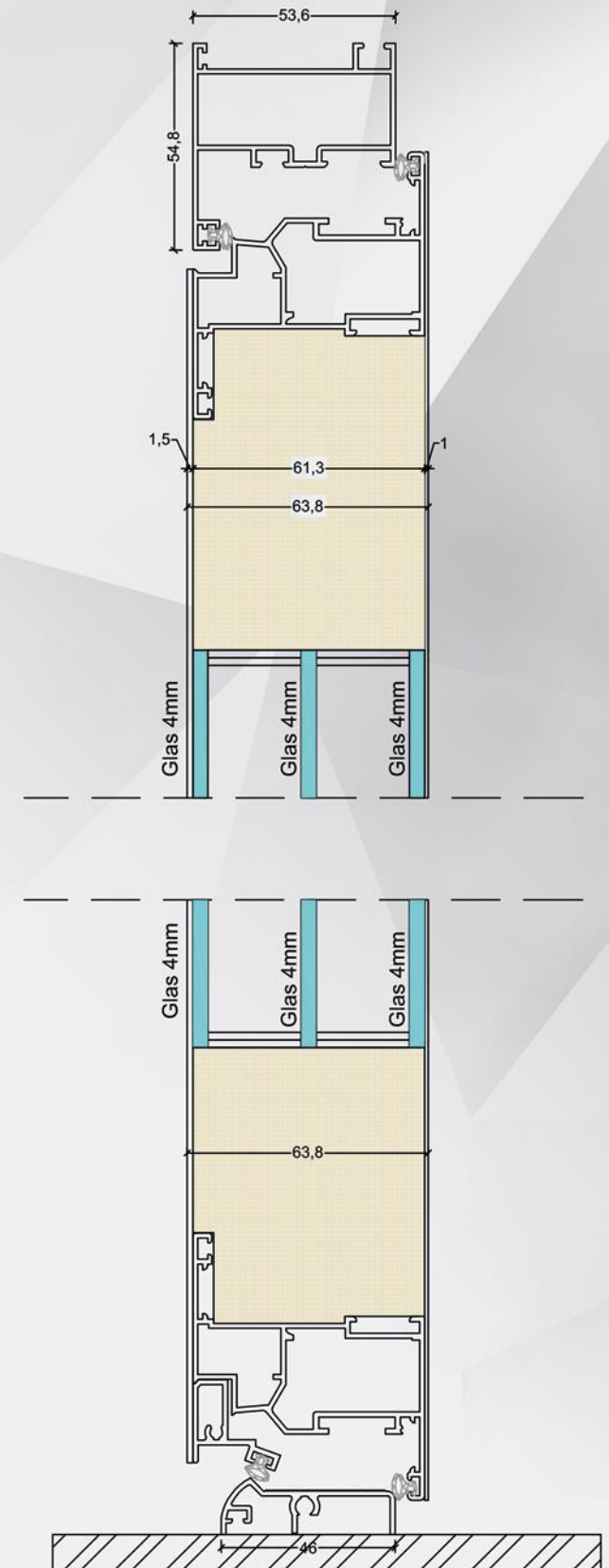

EXTRA EQUIPMENT



Key Protection
EX-705



Key Protection
EX-704



Bluetooth
opening system
EX-402



Fingercan
opening system
EX-401



Keyboard
opening system
EX-403

| V175 Round Handle on sash | |
|------------------------------|--------|
| KQΔ / CODE | L (mm) |
| V175.30.400 | 400 |
| V175.30.600 | 600 |
| V175.30.800 | 800 |
| V175.30.1000 | 1000 |
| V175.30.1200 | 1200 |
| V175.30.1400 | 1400 |
| V175.30.1600 | 1600 |
| V175.30.1800 | 1800 |



| V170 Round Handle on panel | |
|-------------------------------|--------|
| KQΔ / CODE | L (mm) |
| V170.40.400 | 400 |
| V170.40.600 | 600 |
| V170.40.800 | 800 |
| V170.40.1000 | 1000 |
| V170.40.1200 | 1200 |
| V170.40.1400 | 1400 |
| V170.40.1600 | 1600 |
| V170.40.1800 | 1800 |



| V235 Angular Handle on sash | |
|--------------------------------|--------|
| KQΔ / CODE | L (mm) |
| V235.50.400 | 400 |
| V235.50.600 | 600 |
| V235.50.800 | 800 |
| V235.50.1000 | 1000 |
| V235.50.1200 | 1200 |
| V235.50.1400 | 1400 |
| V235.50.1600 | 1600 |
| V235.50.1800 | 1800 |



| V440 Angular Handle on panel | |
|---------------------------------|--------|
| KQΔ / CODE | L (mm) |
| V440.60.400 | 400 |
| V440.60.600 | 600 |
| V440.60.800 | 800 |
| V440.60.1000 | 1000 |
| V440.60.1200 | 1200 |
| V440.60.1400 | 1400 |
| V440.60.1600 | 1600 |
| V440.60.1800 | 1800 |



| V145 Arched Handle | |
|-----------------------|--------|
| KQΔ / CODE | L (mm) |
| V145.80.500 | 500 |
| V145.80.800 | 800 |
| V145.80.1000 | 1000 |
| V145.80.1200 | 1200 |
| V145.80.1400 | 1400 |



| V70 Angular Handle on sash with integrated finger scan | |
|--|--------|
| KQΔ / CODE | L (mm) |
| V70.1200 | 1200 |



| V90 / V90F (FINGERPRINT) | |
|--------------------------|--------|
| KQΔ / CODE | L (mm) |
| V90 | 400 |
| V90 F (Fingerprint) | 400 |



| V810 (L=826 D=400) Handle on panel | |
|---------------------------------------|--------|
| KQΔ / CODE | L (mm) |
| V810 | 826 |



Foot protection - EX-707



Foot protection - EX-706

0 1 2 3 4 5 6 7 8 9

Numbers from stainless steel - EX-708

0 1 2 3 4 5 6 7 8 9

Numbers from glass inside panel - EX-709



| V820 Hidden Handle in panel | |
|--------------------------------|----------|
| KQΔ / CODE | L (mm) |
| V820 | 200-2000 |

EXTRA EQUIPMENT

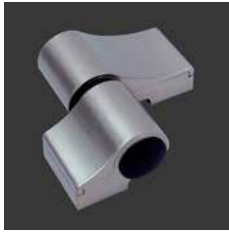

Hinge
EX-301



Hidden Hinge
EX-303



Hinge
EX-304



Hinges safety
EX-310



Safety Rosette
EX-902



Safety Rosette
EX-903



Safety Rosette
EX-904



Safety Rosette
EX-905



Cylinder with keys
in and out EX-203



Safety cylinder
EX-200



Electric strike
EX-400



Block (EX-105)
EX-409



Spyhole
EX-404



Spyhole with
camera EX-405



Door closer
EX-600



Door closer
EX-601



Inside Handle
ID 20 EX-500



Inside Handle
ID 30 EX-501



Inside Handle
ID 35 EX-502

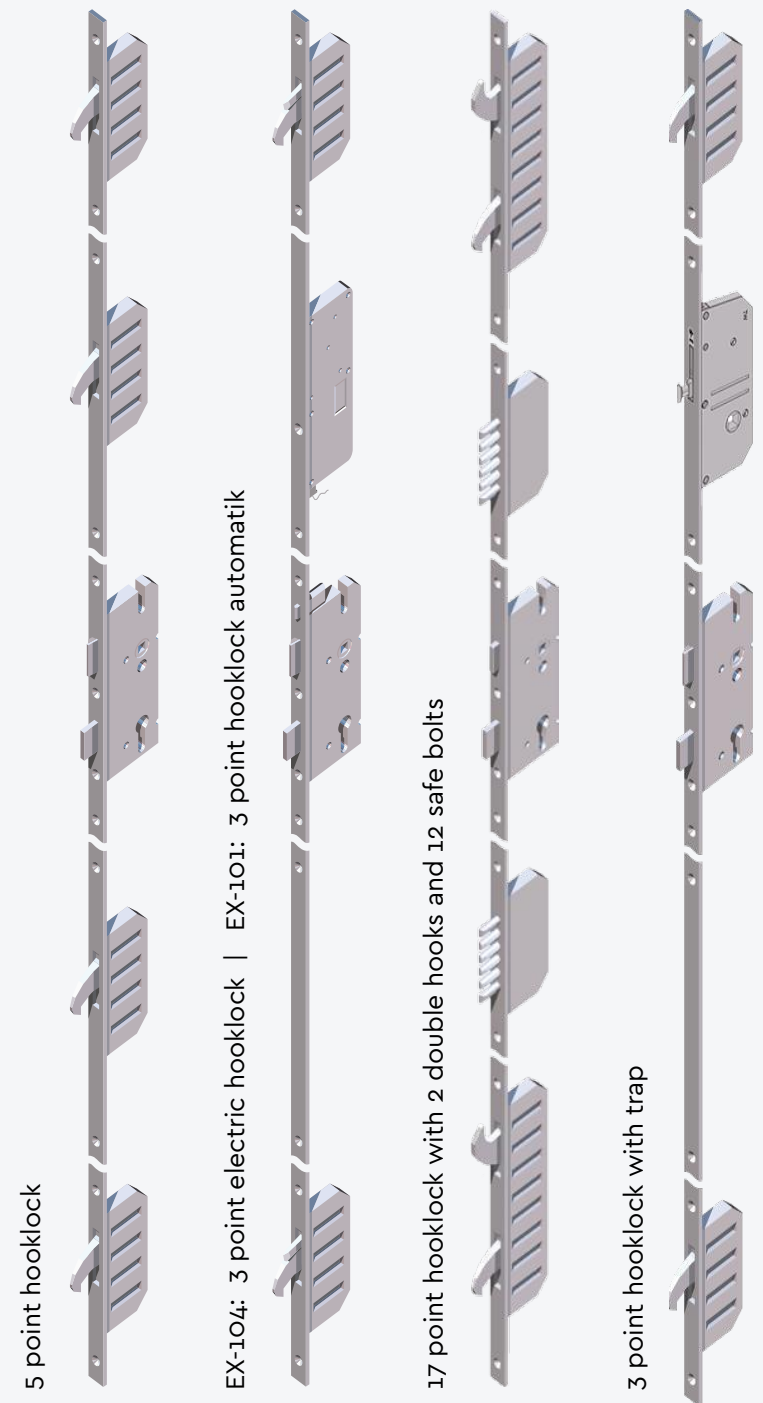

5 point hooklock

EX-104: 3 point electric hooklock | EX-101: 3 point hooklock automatic

17 point hooklock with 2 double hooks and 12 safe bolts

3 point hooklock with trap

EX-102

EX-104
EX-101

EX-103

EX-105

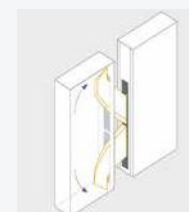
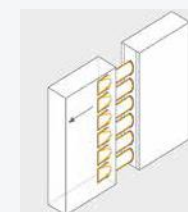
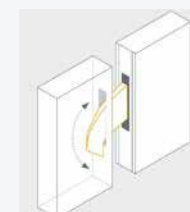



7.5 klm. Veria - Naousa
GR 59132, P.O. Box 130
Veria, Greece

Tel: +30 23310 93025
+30 23310 93285
Fax: +30 23310 93085

www.verpan.gr
email: info@verpan.gr