

Sound Insulation

According to
ISO 140/3

A5

Authorizing Company: ETEM S.A.

Dimensions in mm

Specimen description:

Single sash side/bottom hung
aluminium window E-45 series

Area : 1,9 m²

Total glazing thickness: 28 mm

Layers:

Thermal insulating glazing
6+18+4 mm

Two rubber seals between
sash frame and glazing

Three rubber seals between
sash and frame

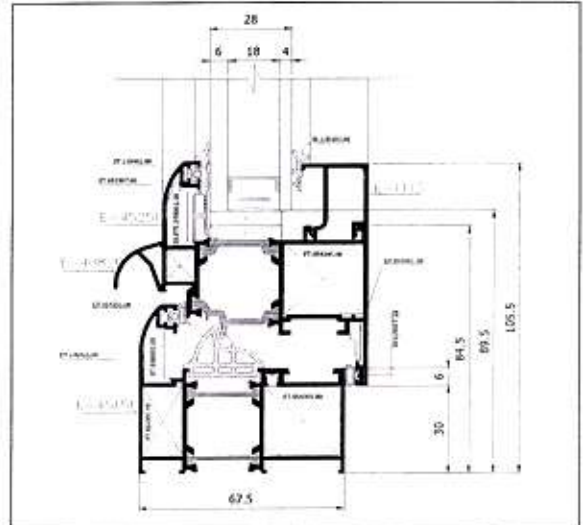

Test rooms:

Volumes:

$V_{source} = 29,7 \text{ m}^3$

$V_{receiving} = 43,8 \text{ m}^3$

Type of room : Laboratory test room

Room condition: Empty

Excitation : White noise

Filter : 1/3 octave

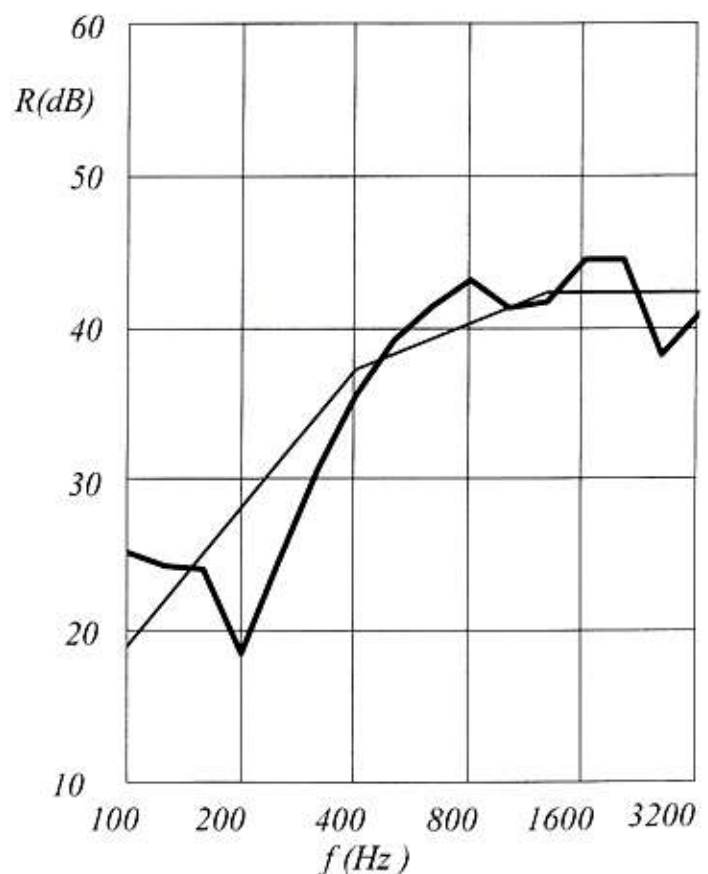

Evaluation according to ISO 717/1

Weighted Sound Reduction Index

$R_w = 38 \text{ dB}$

f(Hz): 100 125 160 200 250 315 400 500 630 800 1000 1250 1600 2000 2500 3150
R(dB): 25,1 24,2 24,0 18,5 24,6 30,4 35,3 38,9 41,1 42,8 41,0 41,4 44,1 44,1 37,9 40,6

Test number: **A5.373.05**

Date of test: 16.05.2005 C

School of Architecture - Faculty of Technology - A.U.TH.

Architectural Technology Laboratory

Director) E.Tzekakis

Signature