

EW70 Opening Window System

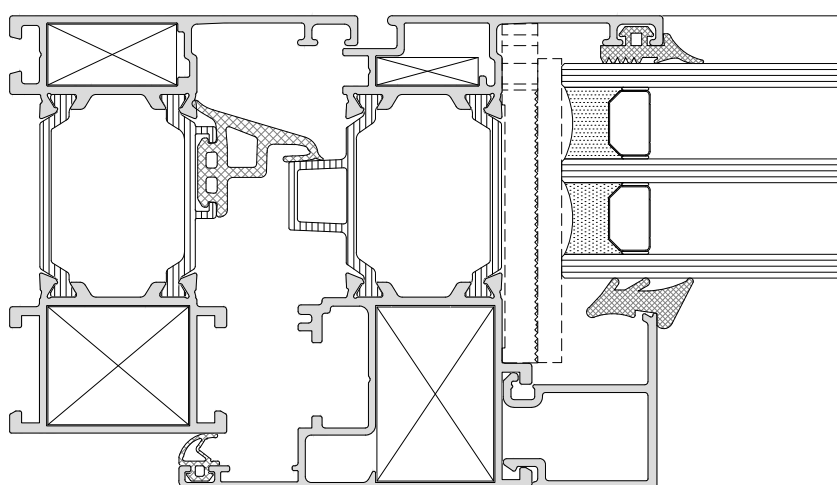

Designed to meet the market needs EW70 is a high thermally efficient windows system offering very good level of functionality and quality. The EW70 profiles respect the modern narrow lines, high stability and loading capacity requirements.



Technical features

- Elegant straight design
- Variety of profiles
- Double & triple glazing option
- Glazing infill range: 17 ÷ 52 mm
- Fixed frame (min. depth): 70 mm
- Vent leaf (min. depth): 79.5 mm

Hardware accessories

- Eurogroove & PVC groove
- Max. leaf weight: 130 kg

Performance

Air Permeability:	Class 4
Watertightness:	up to Class 9A
Resistance to wind load:	Class C4
Impact Resistance:	Class 4
Thermal transmittance (U_f):	from 1.4 W/(m²K)
Operating forces:	Class 1
Mechanical properties:	Class 2

Surface treatment options

- RAL colours
- ETEM colours
- Anodising
- Wood effects
- Quality Standards:
 - QUALICOAT
 - QUALIDECO
 - QUALANOD

Typologies

- Turn, tilt & turn, tilt, fixed, door-height window
- Inward opening
- Single & double leaf

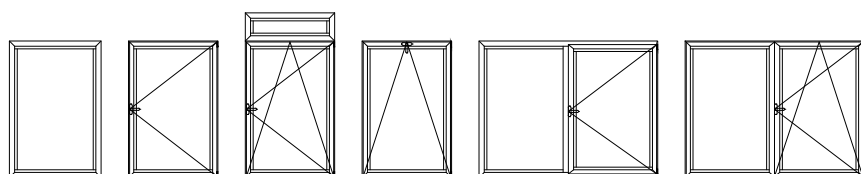

Production certificates

- EN ISO 9001
- EN ISO 14001
- OHSAS 18001

